

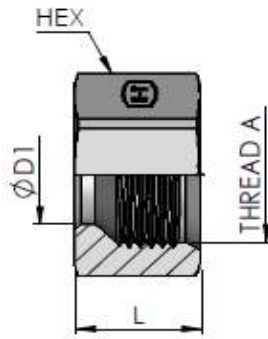

C-01



**N-NUT
L SERIES**

| Tube O.D. | HEX | ØD1 | L Length | A THREAD | Part Number | Torque N-m | Working pressure in Bar |
|-----------|-------|-------|----------|------------|-------------|------------|-------------------------|
| 6 | 14.00 | 6.00 | 14.50 | M12X1.5-6H | N06L | 13-15 | 250 |
| 8 | 17.00 | 8.00 | 14.50 | M14X1.5-6H | N08L | 15-18 | 250 |
| 10 | 19.00 | 10.00 | 15.50 | M16X1.5-6H | N10L | 25-28 | 250 |
| 12 | 22.00 | 12.00 | 15.50 | M18X1.5-6H | N12L | 27-30 | 250 |
| 15 | 27.00 | 15.00 | 17.00 | M22X1.5-6H | N15L | 50-60 | 250 |
| 18 | 32.00 | 18.00 | 18.00 | M26X1.5-6H | N18L | 60-75 | 160 |
| 22 | 36.00 | 22.00 | 20.00 | M30X2.0-6H | N22L | 85-105 | 160 |
| 28 | 41.00 | 28.00 | 21.00 | M36X2.0-6H | N28L | 120-140 | 100 |
| 35 | 50.00 | 35.00 | 24.00 | M45X2.0-6H | N35L | 170-190 | 100 |
| 42 | 60.00 | 42.00 | 24.00 | M52X2.0-6H | N42L | 190-230 | 100 |

S SERIES

| Tube O.D. | HEX | ØD1 | L Length | A THREAD | PartXNum ber | Torque N-m | Working pressure in Bar |
|-----------|-------|-------|----------|------------|--------------|------------|-------------------------|
| 6 | 17.00 | 6.00 | 16.50 | M14X1.5-6H | N06S | 14-16 | 630 |
| 8 | 19.00 | 8.00 | 16.50 | M16X1.5-6H | N08S | 25-28 | 630 |
| 10 | 22.00 | 10.00 | 17.50 | M18X1.5-6H | N10S | 27-30 | 630 |
| 12 | 24.00 | 12.00 | 17.50 | M20X1.5-6H | N12S | 43-54 | 630 |
| 14 | 27.00 | 14.00 | 20.50 | M22X1.5-6H | N14S | 50-62 | 630 |
| 16 | 30.00 | 16.00 | 20.50 | M24X1.5-6H | N106S | 60-75 | 400 |
| 20 | 36.00 | 20.00 | 24.00 | M30X2.0-6H | N20S | 90-110 | 400 |
| 25 | 46.00 | 25.00 | 27.00 | M36X2.0-6H | N25S | 125-145 | 400 |
| 30 | 50.00 | 30.00 | 29.00 | M42X2.0-6H | N30S | 170-190 | 250 |
| 38 | 60.00 | 38.00 | 32.50 | M52X2.0-6H | N38S | 200-245 | 250 |

| Material | Suffix surface and material | Example |
|-------------------------------------|-----------------------------|------------|
| Steel ,Zinc plated chrome (VI)-free | | N06L |
| Steel ,Zinc nickel plated | ZiNi | N06L-ZINI |
| Stainless Steel-SS316 | SS316 | N06L-SS316 |
| Stainless Steel-SS304 | SS304 | N06L-SS304 |



C-02

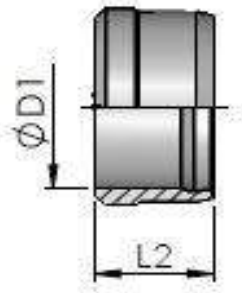

F-FERRULE

L SERIES

| Tube O.D. | ØD1 | L2 Length | Part Number | Torque N-m | Working pressure in Bar |
|-----------|-------|-----------|---------------|------------|-------------------------|
| 6 | 6.00 | 9.00 | F06L-S | 13-15 | 250 |
| 8 | 8.00 | 9.00 | F08L-S | 15-18 | 250 |
| 10 | 10.00 | 10.00 | F10L-S | 25-28 | 250 |
| 12 | 12.00 | 10.00 | F12L-S | 27-30 | 250 |
| 15 | 15.00 | 10.00 | F15L | 50-60 | 250 |
| 18 | 18.00 | 10.00 | F18L | 60-75 | 160 |
| 22 | 22.00 | 10.50 | F22L | 85-105 | 160 |
| 28 | 28.00 | 10.50 | F28L | 120-140 | 100 |
| 35 | 35.00 | 13.00 | F35L | 170-190 | 100 |
| 42 | 42.00 | 13.50 | F42L | 190-230 | 100 |

S SERIES

| Tube O.D. | ØD1 | L2 Length | Part Number | Torque N-m | Working pressure in Bar |
|-----------|-------|-----------|---------------|------------|-------------------------|
| 6 | 6.00 | 9.00 | F06L-S | 14-16 | 630 |
| 8 | 8.00 | 9.00 | F08L-S | 25-28 | 630 |
| 10 | 10.00 | 10.00 | F10L-S | 27-30 | 630 |
| 12 | 12.00 | 10.00 | F12L-S | 43-54 | 630 |
| 14 | 14.00 | 10.00 | F14S | 50-62 | 630 |
| 16 | 16.00 | 10.50 | F16S | 60-75 | 400 |
| 20 | 20.00 | 12.50 | F20S | 90-110 | 400 |
| 25 | 25.00 | 12.50 | F25S | 125-145 | 400 |
| 30 | 30.00 | 13.00 | F30S | 170-190 | 250 |
| 38 | 38.00 | 13.50 | F38S | 200-245 | 250 |

| Material | Suffix surface and material | Example |
|-------------------------------------|-----------------------------|-------------|
| Steel ,Zinc plated chrome (VI)-free | | F06L-S |
| Steel ,Zinc nickel plated | ZiNi | F06L-S-ZINI |

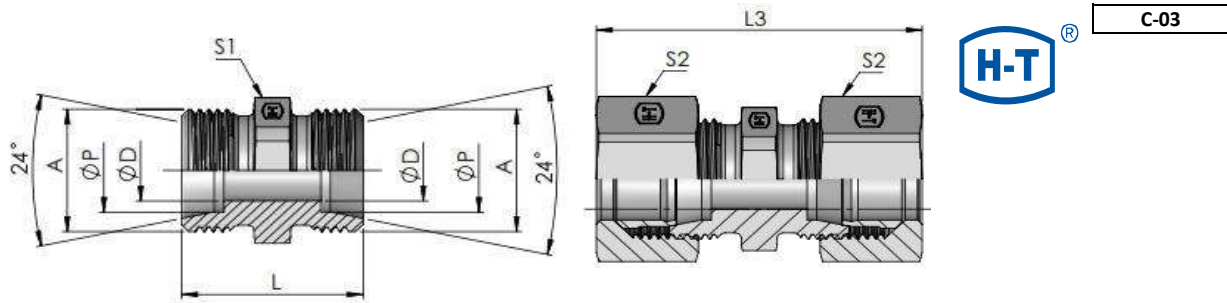

G-Equal Straight Coupling

L SERIES

| Tube O.D. | A THREAD | S1 Hex | S2 Hex | L Length | ØD DRILL | ØP | L3 | Body Part Number | Assembly Part Number | Torque N-m | Working pressure in Bar |
|-----------|------------|--------|--------|----------|----------|-------|-------|------------------|----------------------|------------|-------------------------|
| 6 | M12X1.5-6g | 12.00 | 14.00 | 24.00 | 4.00 | 6.00 | 39.00 | XG06L | G06L | 13-15 | 250 |
| 8 | M14X1.5-6g | 14.00 | 17.00 | 25.00 | 6.00 | 8.00 | 40.00 | XG08L | G08L | 15-18 | 250 |
| 10 | M16X1.5-6g | 17.00 | 19.00 | 27.00 | 8.00 | 10.00 | 42.00 | XG10L | G10L | 25-28 | 250 |
| 12 | M18X1.5-6g | 19.00 | 22.00 | 28.00 | 10.00 | 12.00 | 43.00 | XG12L | G12L | 27-30 | 250 |
| 15 | M22X1.5-6g | 24.00 | 27.00 | 30.00 | 12.00 | 15.00 | 46.00 | XG15L | G15L | 50-60 | 250 |
| 18 | M26X1.5-6g | 27.00 | 32.00 | 31.00 | 15.00 | 18.00 | 48.00 | XG18L | G18L | 60-75 | 160 |
| 22 | M30X2.0-6g | 32.00 | 36.00 | 35.00 | 19.00 | 22.00 | 52.00 | XG22L | G22L | 85-105 | 160 |
| 28 | M36X2.0-6g | 41.00 | 41.00 | 36.00 | 24.00 | 28.00 | 54.00 | XG28L | G28L | 120-140 | 100 |
| 35 | M45X2.0-6g | 46.00 | 50.00 | 41.00 | 30.00 | 35.00 | 63.00 | XG35L | G35L | 170-190 | 100 |
| 42 | M52X2.0-6g | 55.00 | 60.00 | 43.00 | 36.00 | 42.00 | 66.00 | XG42L | G42L | 190-230 | 100 |

S SERIES

| Tube O.D. | A THREAD | S1 Hex | S2 Hex | L Length | ØD DRILL | ØP | L3 | Body Part Number | Assembly Part Number | Torque N-m | Working pressure in Bar |
|-----------|------------|--------|--------|----------|----------|-------|-------|------------------|----------------------|------------|-------------------------|
| 6 | M14X1.5-6g | 14.00 | 17.00 | 30.00 | 4.00 | 6.00 | 45.00 | XG06S | G06S | 14-16 | 630 |
| 8 | M16X1.5-6g | 17.00 | 19.00 | 32.00 | 5.00 | 8.00 | 47.00 | XG08S | G08S | 25-28 | 630 |
| 10 | M18X1.5-6g | 19.00 | 22.00 | 32.00 | 7.00 | 10.00 | 49.00 | XG10S | G10S | 27-30 | 630 |
| 12 | M20X1.5-6g | 22.00 | 24.00 | 34.00 | 8.00 | 12.00 | 51.00 | XG12S | G12S | 43-54 | 630 |
| 16 | M24X1.5-6g | 27.00 | 30.00 | 38.00 | 12.00 | 16.00 | 57.00 | XG16S | G16S | 60-75 | 400 |
| 20 | M30X2.0-6g | 32.00 | 36.00 | 44.00 | 16.00 | 20.00 | 66.00 | XG20S | G20S | 90-110 | 400 |
| 25 | M36X2.0-6g | 41.00 | 46.00 | 50.00 | 20.00 | 25.00 | 74.00 | XG25S | G25S | 125-145 | 400 |
| 30 | M42X2.0-6g | 46.00 | 50.00 | 54.00 | 25.00 | 30.00 | 80.00 | XG30S | G30S | 170-190 | 250 |
| 38 | M52X2.0-6g | 55.00 | 60.00 | 61.00 | 32.00 | 38.00 | 90.00 | XG38S | G38S | 200-245 | 250 |

| Material | Suffix surface and material | Example |
|-------------------------------------|-----------------------------|-------------|
| Steel ,Zinc plated chrome (VI)-free | | XG06L |
| Steel ,Zinc nickel plated | ZiNi | XG06L-ZINI |
| Stainless Steel-SS316 | SS316 | XG06L-SS316 |
| Stainless Steel-SS304 | SS304 | XG06L-SS304 |

C-04

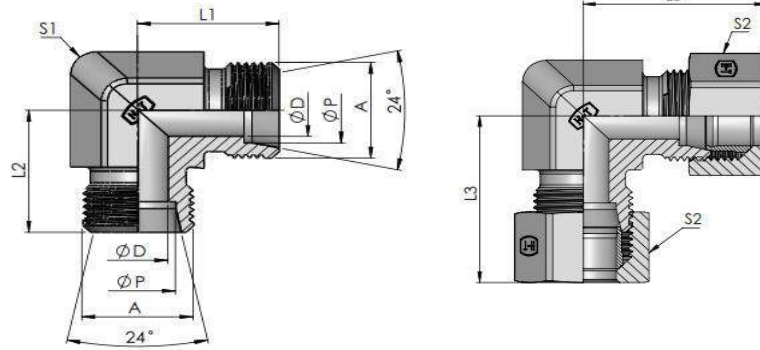

W-Equal Elbow Union

L SERIES

| Tube O.D. | A THREAD | S1 Hex | S2 Hex | L1 | L2 | ØD DRILL | ØP | L3 | Body Part Number | Assembly Part Number | Torque N-m | Working pressure in Bar |
|-----------|------------|--------|--------|-------|-------|----------|-------|-------|------------------|----------------------|------------|-------------------------|
| 6 | M12X1.5-6g | 12.00 | 14.00 | 19.00 | 19.00 | 4.00 | 6.00 | 27.00 | XW06L | W06L | 13-15 | 250 |
| 8 | M14X1.5-6g | 14.00 | 17.00 | 21.00 | 21.00 | 6.00 | 8.00 | 29.00 | XW08L | W08L | 15-18 | 250 |
| 10 | M16X1.5-6g | 14.00 | 19.00 | 22.00 | 22.00 | 8.00 | 10.00 | 30.00 | XW10L | W10L | 25-28 | 250 |
| 12 | M18X1.5-6g | 17.00 | 22.00 | 24.00 | 24.00 | 10.00 | 12.00 | 32.00 | XW12L | W12L | 27-30 | 250 |
| 15 | M22X1.5-6g | 24.00 | 27.00 | 28.00 | 28.00 | 12.00 | 15.00 | 36.00 | XW15L | W15L | 50-60 | 250 |
| 18 | M26X1.5-6g | 24.00 | 32.00 | 31.00 | 31.00 | 15.00 | 18.00 | 40.00 | XW18L | W18L | 60-75 | 160 |
| 22 | M30X2.0-6g | 27.00 | 36.00 | 35.00 | 35.00 | 19.00 | 22.00 | 44.00 | XW22L | W22L | 85-105 | 160 |
| 28 | M36X2.0-6g | 36.00 | 41.00 | 38.00 | 38.00 | 24.00 | 28.00 | 47.00 | XW28L | W28L | 120-140 | 100 |
| 35 | M45X2.0-6g | 41.00 | 50.00 | 45.00 | 45.00 | 30.00 | 35.00 | 56.00 | XW35L | W35L | 170-190 | 100 |
| 42 | M52X2.0-6g | 50.00 | 60.00 | 51.00 | 51.00 | 36.00 | 42.00 | 63.00 | XW42L | W42L | 190-230 | 100 |

S SERIES

| Tube O.D. | A THREAD | S1 Hex | S2 Hex | L1 | L2 | ØD DRILL | ØP | L3 | Body Part Number | Assembly Part Number | Torque N-m | Working pressure in Bar |
|-----------|------------|--------|--------|-------|-------|----------|-------|-------|------------------|----------------------|------------|-------------------------|
| 6 | M14X1.5-6g | 14.00 | 17.00 | 23.00 | 23.00 | 4.00 | 6.00 | 31.00 | XW06S | W06S | 14-16 | 630 |
| 8 | M16X1.5-6g | 14.00 | 19.00 | 24.00 | 24.00 | 5.00 | 8.00 | 32.00 | XW08S | W08S | 25-28 | 630 |
| 10 | M18X1.5-6g | 17.00 | 22.00 | 25.00 | 25.00 | 7.00 | 10.00 | 34.00 | XW10S | W10S | 27-30 | 630 |
| 12 | M20X1.5-6g | 17.00 | 24.00 | 29.00 | 29.00 | 8.00 | 12.00 | 38.00 | XW12S | W12S | 43-54 | 630 |
| 14 | M22X1.5-6g | 24.00 | 27.00 | 30.00 | 30.00 | 10.00 | 14.00 | 40.00 | XW14S | W14S | 50-62 | 630 |
| 16 | M24X1.5-6g | 24.00 | 30.00 | 33.00 | 33.00 | 12.00 | 16.00 | 43.00 | XW16S | W16S | 60-75 | 400 |
| 20 | M30X2.0-6g | 27.00 | 36.00 | 37.00 | 37.00 | 16.00 | 20.00 | 48.00 | XW20S | W20S | 90-110 | 400 |
| 25 | M36X2.0-6g | 36.00 | 46.00 | 42.00 | 42.00 | 20.00 | 25.00 | 54.00 | XW25S | W25S | 125-145 | 400 |
| 30 | M42X2.0-6g | 41.00 | 50.00 | 49.00 | 49.00 | 25.00 | 30.00 | 62.00 | XW30S | W30S | 170-190 | 250 |
| 38 | M52X2.0-6g | 50.00 | 60.00 | 57.00 | 57.00 | 32.00 | 38.00 | 72.00 | XW38S | W38S | 200-245 | 250 |

| Material | Suffix surface and material | Example |
|-------------------------------------|-----------------------------|-------------|
| Steel ,Zinc plated chrome (VI)-free | | XW06L |
| Steel ,Zinc nickel plated | ZiNi | XW06L-ZINI |
| Stainless Steel-SS316 | SS316 | XW06L-SS316 |
| Stainless Steel-SS304 | SS304 | XW06L-SS304 |

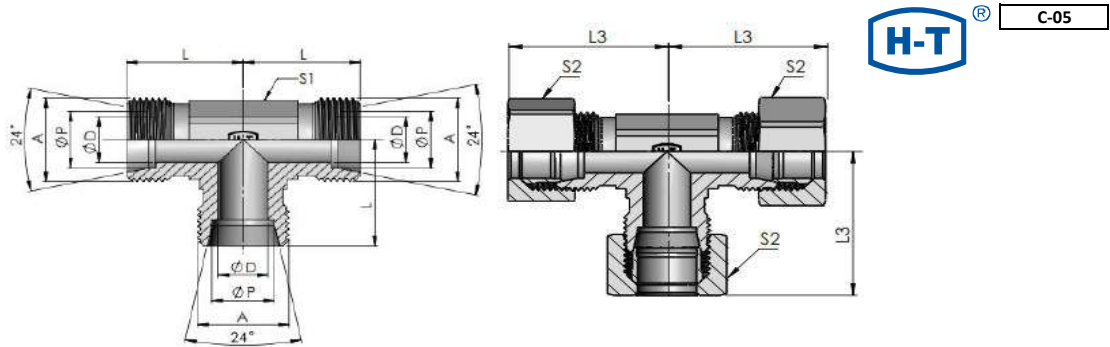

T-Equal Tee Union

L SERIES

| Tube O.D. | A THREAD | S1 Hex | S2 Hex | L | ØD DRILL | ØP | L3 | Body Part Number | Assembly Part Number | Torque N-m | Working pressure in Bar |
|-----------|------------|--------|--------|-------|----------|-------|-------|------------------|----------------------|------------|-------------------------|
| 6 | M12X1.5-6g | 12.00 | 14.00 | 19.00 | 4.00 | 6.00 | 27.00 | XT06L | T06L | 13-15 | 250 |
| 8 | M14X1.5-6g | 14.00 | 17.00 | 21.00 | 6.00 | 8.00 | 29.00 | XT08L | T08L | 15-18 | 250 |
| 10 | M16X1.5-6g | 14.00 | 19.00 | 22.00 | 8.00 | 10.00 | 30.00 | XT10L | T10L | 25-28 | 250 |
| 12 | M18X1.5-6g | 17.00 | 22.00 | 24.00 | 10.00 | 12.00 | 32.00 | XT12L | T12L | 27-30 | 250 |
| 15 | M22X1.5-6g | 19.00 | 27.00 | 28.00 | 12.00 | 15.00 | 36.00 | XT15L | T15L | 50-60 | 250 |
| 18 | M26X1.5-6g | 24.00 | 32.00 | 31.00 | 15.00 | 18.00 | 40.00 | XT18L | T18L | 60-75 | 160 |
| 22 | M30X2.0-6g | 27.00 | 36.00 | 35.00 | 19.00 | 22.00 | 44.00 | XT22L | T22L | 85-105 | 160 |
| 28 | M36X2.0-6g | 36.00 | 41.00 | 38.00 | 24.00 | 28.00 | 47.00 | XT28L | T28L | 120-140 | 100 |
| 35 | M45X2.0-6g | 41.00 | 50.00 | 45.00 | 30.00 | 35.00 | 56.00 | XT35L | T35L | 170-190 | 100 |
| 42 | M52X2.0-6g | 50.00 | 60.00 | 51.00 | 36.00 | 42.00 | 63.00 | XT42L | T42L | 190-230 | 100 |

S SERIES

| Tube O.D. | A THREAD | S1 Hex | S2 Hex | L | ØD DRILL | ØP | L3 | Body Part Number | Assembly Part Number | Torque N-m | Working pressure in Bar |
|-----------|------------|--------|--------|-------|----------|-------|-------|------------------|----------------------|------------|-------------------------|
| 6 | M14X1.5-6g | 14.00 | 17.00 | 23.00 | 4.00 | 6.00 | 31.00 | XT06S | T06S | 14-16 | 630 |
| 8 | M16X1.5-6g | 14.00 | 19.00 | 24.00 | 5.00 | 8.00 | 32.00 | XT08S | T08S | 25-28 | 630 |
| 10 | M18X1.5-6g | 17.00 | 22.00 | 25.00 | 7.00 | 10.00 | 34.00 | XT10S | T10S | 27-30 | 630 |
| 12 | M20X1.5-6g | 17.00 | 24.00 | 29.00 | 8.00 | 12.00 | 38.00 | XT12S | T12S | 43-54 | 630 |
| 14 | M22X1.5-6g | 24.00 | 27.00 | 30.00 | 10.00 | 14.00 | 40.00 | XT14S | T12S | 50-62 | 630 |
| 16 | M24X1.5-6g | 24.00 | 30.00 | 33.00 | 12.00 | 16.00 | 43.00 | XT16S | T16S | 60-75 | 400 |
| 20 | M30X2.0-6g | 27.00 | 36.00 | 37.00 | 16.00 | 20.00 | 48.00 | XT20S | T20S | 90-110 | 400 |
| 25 | M36X2.0-6g | 36.00 | 46.00 | 42.00 | 20.00 | 25.00 | 54.00 | XT25S | T25S | 125-145 | 400 |
| 30 | M42X2.0-6g | 41.00 | 50.00 | 49.00 | 25.00 | 30.00 | 62.00 | XT30S | T30S | 170-190 | 250 |
| 38 | M52X2.0-6g | 50.00 | 60.00 | 57.00 | 32.00 | 38.00 | 72.00 | XT38S | T38S | 200-245 | 250 |

| Material | Suffix surface and material | Example |
|-------------------------------------|-----------------------------|-------------|
| Steel ,Zinc plated chrome (VI)-free | | XT06L |
| Steel ,Zinc nickel plated | ZiNi | XT06L-ZiNi |
| Stainless Steel-SS316 | SS316 | XT06L-SS316 |
| Stainless Steel-SS304 | SS304 | XT06L-SS304 |

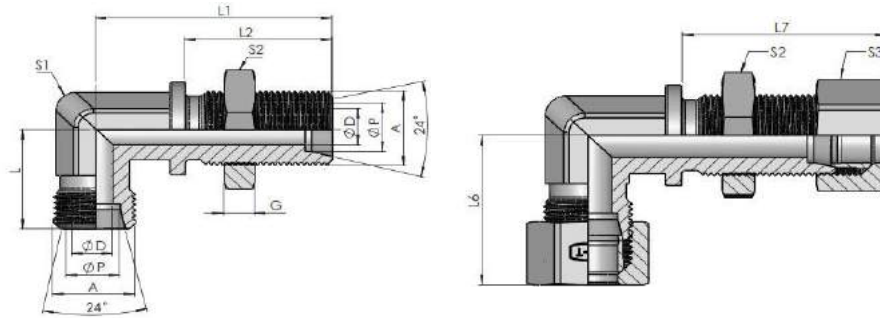

WSV-Bulkhead Union Elbow

L SERIES

| Tube O.D. | A THREAD | S1 Hex | S2 Hex | S3 Hex | L | L1 | L2 | ØD DRILL | ØP | G | L6 | L7 | Body Part Number | Assembly Part Number | Torque N-m | Working pressure in Bar |
|-----------|------------|--------|--------|--------|-------|-------|-------|----------|-------|-------|-------|-------|------------------|----------------------|------------|-------------------------|
| 6 | M12X1.5-6g | 12.00 | 17.00 | 14.00 | 20.50 | 48.00 | 34.00 | 4.00 | 6.00 | 5.00 | 27.00 | 42.00 | XWSV06L | WSV06L | 13-15 | 250 |
| 8 | M14X1.5-6g | 12.00 | 19.00 | 17.00 | 21.00 | 51.00 | 34.00 | 6.00 | 8.00 | 5.50 | 29.00 | 42.00 | XWSV08L | WSV08L | 15-18 | 250 |
| 10 | M16X1.5-6g | 14.00 | 22.00 | 19.00 | 25.00 | 53.00 | 35.00 | 8.00 | 10.00 | 6.00 | 30.00 | 43.00 | XWSV10L | WSV10L | 25-28 | 250 |
| 12 | M18X1.5-6g | 17.00 | 24.00 | 22.00 | 26.50 | 56.00 | 36.00 | 10.00 | 12.00 | 7.00 | 32.00 | 44.00 | XWSV12L | WSV12L | 27-30 | 250 |
| 15 | M22X1.5-6g | 24.00 | 30.00 | 27.00 | 28.00 | 61.00 | 38.00 | 12.00 | 15.00 | 8.00 | 36.00 | 46.00 | XWSV15L | WSV15L | 50-60 | 250 |
| 18 | M26X1.5-6g | 24.00 | 36.00 | 32.00 | 31.00 | 64.00 | 40.00 | 15.00 | 18.00 | 8.00 | 40.00 | 49.00 | XWSV18L | WSV18L | 60-75 | 160 |
| 22 | M30X2.0-6g | 27.00 | 41.00 | 36.00 | 35.00 | 72.00 | 42.00 | 19.00 | 22.00 | 10.00 | 44.00 | 51.00 | XWSV22L | WSV22L | 85-105 | 160 |
| 28 | M36X2.0-6g | 36.00 | 46.00 | 41.00 | 38.00 | 77.00 | 43.00 | 24.00 | 28.00 | 12.00 | 47.00 | 52.00 | XWSV28L | WSV28L | 120-140 | 100 |
| 35 | M45X2.0-6g | 41.00 | 55.00 | 50.00 | 42.00 | 86.00 | 47.00 | 30.00 | 35.00 | 11.00 | 56.00 | 58.00 | XWSV35L | WSV35L | 170-190 | 100 |
| 42 | M52X2.0-6g | 50.00 | 65.00 | 60.00 | 51.00 | 90.00 | 47.00 | 36.00 | 42.00 | 14.00 | 63.00 | 59.00 | XWSV42L | WSV42L | 190-230 | 100 |

S SERIES

| Tube O.D. | A THREAD | S1 Hex | S2 Hex | S3 Hex | L | L1 | L2 | ØD DRILL | ØP | G | L6 | L7 | Body Part Number | Assembly Part Number | Torque N-m | Working pressure in Bar |
|-----------|------------|--------|--------|--------|-------|-------|-------|----------|-------|-------|-------|-------|------------------|----------------------|------------|-------------------------|
| 6 | M14X1.5-6g | 12.00 | 19.00 | 17.00 | 23.00 | 53.00 | 36.00 | 4.00 | 6.00 | 5.50 | 31.00 | 44.00 | XWSV06S | WSV06S | 14-16 | 630 |
| 8 | M16X1.5-6g | 14.00 | 22.00 | 19.00 | 24.00 | 54.00 | 36.00 | 5.00 | 8.00 | 6.00 | 32.00 | 44.00 | XWSV08S | WSV08S | 25-28 | 630 |
| 10 | M18X1.5-6g | 17.00 | 24.00 | 22.00 | 25.00 | 57.00 | 37.00 | 7.00 | 10.00 | 7.00 | 34.00 | 46.00 | XWSV10S | WSV10S | 27-30 | 630 |
| 12 | M20X1.5-6g | 17.00 | 27.00 | 24.00 | 29.00 | 59.00 | 38.00 | 8.00 | 12.00 | 7.00 | 38.00 | 47.00 | XWSV12S | WSV12S | 43-54 | 630 |
| 14 | M22X1.5-6g | 19.00 | 30.00 | 27.00 | 30.00 | 63.00 | 40.00 | 10.00 | 14.00 | 8.00 | 40.00 | 50.00 | XWSV14S | WSV14S | 50-62 | 630 |
| 16 | M24X1.5-6g | 24.00 | 32.00 | 30.00 | 33.00 | 64.00 | 40.00 | 12.00 | 16.00 | 10.00 | 43.00 | 50.00 | XWSV16S | WSV16S | 60-75 | 400 |
| 20 | M30X2.0-6g | 27.00 | 41.00 | 36.00 | 37.00 | 74.00 | 44.00 | 16.00 | 20.00 | 10.00 | 48.00 | 55.00 | XWSV20S | WSV20S | 90-110 | 400 |
| 25 | M36X2.0-6g | 36.00 | 46.00 | 46.00 | 42.00 | 81.00 | 47.00 | 20.00 | 25.00 | 12.00 | 54.00 | 59.00 | XWSV25S | WSV25S | 125-145 | 400 |
| 30 | M42X2.0-6g | 41.00 | 50.00 | 50.00 | 49.00 | 90.00 | 51.00 | 25.00 | 30.00 | 11.00 | 62.00 | 64.00 | XWSV30S | WSV30S | 170-190 | 250 |
| 38 | M52X2.0-6g | 50.00 | 65.00 | 60.00 | 57.00 | 96.00 | 53.00 | 32.00 | 38.00 | 14.00 | 72.00 | 68.00 | XWSV38S | WSV38S | 200-245 | 250 |

| Material | Suffix surface and | Example |
|-------------------------------------|--------------------|---------------|
| Steel ,Zinc plated chrome (VI)-free | | XWSV06L |
| Steel ,Zinc nickel plated | ZiNi | XWSV06L-ZiNi |
| Stainless Steel-SS316 | SS316 | XWSV06L-SS316 |
| Stainless Steel-SS304 | SS304 | XWSV06L-SS304 |

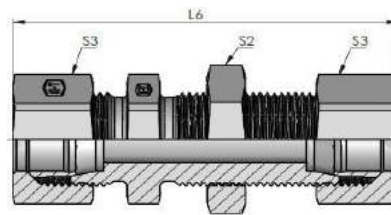
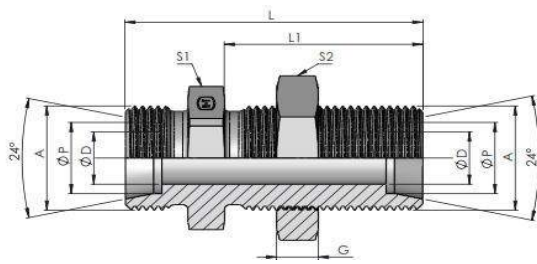

C-07

SV-Bulkhead Straight Coupling

L SERIES

| Tube O.D. | A THREAD | S1 Hex | S2 Hex | S3 Hex | L | L1 | ØD DRILL | ØP | G | L6 | Body Part Number | Assembly Part Number | Torque N-m | Working pressure in Bar |
|-----------|------------|--------|--------|--------|-------|-------|----------|-------|-------|--------|------------------|----------------------|------------|-------------------------|
| 6 | M12X1.5-6g | 17.00 | 17.00 | 14.00 | 48.00 | 34.00 | 4.00 | 6.00 | 5.00 | 64.00 | XSV06L | SV06L | 13-15 | 250 |
| 8 | M14X1.5-6g | 19.00 | 19.00 | 17.00 | 49.00 | 34.00 | 6.00 | 8.00 | 5.50 | 65.00 | XSV08L | SV08L | 15-18 | 250 |
| 10 | M16X1.5-6g | 22.00 | 22.00 | 19.00 | 52.00 | 35.00 | 8.00 | 10.00 | 6.00 | 68.00 | XSV10L | SV10L | 25-28 | 250 |
| 12 | M18X1.5-6g | 24.00 | 24.00 | 22.00 | 53.00 | 36.00 | 10.00 | 12.00 | 7.00 | 69.00 | XSV12L | SV12L | 27-30 | 250 |
| 15 | M22X1.5-6g | 27.00 | 30.00 | 27.00 | 57.00 | 38.00 | 12.00 | 15.00 | 8.00 | 73.00 | XSV15L | SV15L | 50-60 | 250 |
| 18 | M26X1.5-6g | 32.00 | 36.00 | 32.00 | 61.00 | 40.00 | 15.00 | 18.00 | 8.00 | 79.00 | XSV18L | SV18L | 60-75 | 160 |
| 22 | M30X2.0-6g | 36.00 | 41.00 | 36.00 | 66.00 | 42.00 | 19.00 | 22.00 | 10.00 | 84.00 | XSV22L | SV22L | 85-105 | 160 |
| 28 | M36X2.0-6g | 41.00 | 46.00 | 41.00 | 69.00 | 43.00 | 24.00 | 28.00 | 12.00 | 107.00 | XSV28L | SV28L | 120-140 | 100 |
| 35 | M45X2.0-6g | 50.00 | 55.00 | 50.00 | 76.00 | 47.00 | 30.00 | 35.00 | 11.00 | 98.00 | XSV35L | SV35L | 170-190 | 100 |
| 42 | M52X2.0-6g | 60.00 | 65.00 | 60.00 | 77.00 | 47.00 | 36.00 | 42.00 | 14.00 | 101.00 | XSV42L | SV42L | 190-230 | 100 |

S SERIES

| Tube O.D. | A THREAD | S1 Hex | S2 Hex | S3 Hex | L | L1 | ØD DRILL | ØP | G | L6 | Body Part Number | Assembly Part Number | Torque N-m | Working pressure in Bar |
|-----------|------------|--------|--------|--------|-------|-------|----------|-------|-------|--------|------------------|----------------------|------------|-------------------------|
| 6 | M14X1.5-6g | 19.00 | 19.00 | 17.00 | 55.00 | 36.00 | 4.00 | 6.00 | 5.50 | 71.00 | XSV06S | SV06S | 14-16 | 630 |
| 8 | M16X1.5-6g | 22.00 | 22.00 | 19.00 | 56.00 | 36.00 | 5.00 | 8.00 | 6.00 | 72.00 | XSV08S | SV08S | 25-28 | 630 |
| 10 | M18X1.5-6g | 24.00 | 24.00 | 22.00 | 59.00 | 37.00 | 7.00 | 10.00 | 7.00 | 77.00 | XSV10S | SV10S | 27-30 | 630 |
| 12 | M20X1.5-6g | 27.00 | 27.00 | 24.00 | 60.00 | 38.00 | 8.00 | 12.00 | 7.00 | 78.00 | XSV12S | SV12S | 43-54 | 630 |
| 14 | M22X1.5-6g | 30.00 | 30.00 | 27.00 | 64.00 | 40.00 | 10.00 | 14.00 | 8.00 | 85.00 | XSV14S | SV14S | 50-62 | 630 |
| 16 | M24X1.5-6g | 32.00 | 32.00 | 30.00 | 65.00 | 40.00 | 12.00 | 16.00 | 10.00 | 85.00 | XSV16S | SV16S | 60-75 | 400 |
| 20 | M30X2.0-6g | 41.00 | 41.00 | 36.00 | 72.00 | 44.00 | 16.00 | 20.00 | 10.00 | 94.00 | XSV20S | SV20S | 90-110 | 400 |
| 25 | M36X2.0-6g | 46.00 | 46.00 | 46.00 | 79.00 | 47.00 | 20.00 | 25.00 | 12.00 | 103.00 | XSV25S | SV25S | 125-145 | 400 |
| 30 | M42X2.0-6g | 50.00 | 50.00 | 50.00 | 86.00 | 51.00 | 25.00 | 30.00 | 11.00 | 112.00 | XSV30S | SV30S | 170-190 | 250 |
| 38 | M52X2.0-6g | 65.00 | 65.00 | 60.00 | 91.00 | 53.00 | 32.00 | 38.00 | 14.00 | 121.00 | XSV38S | SV38S | 200-245 | 250 |

| Material | Suffix surface and material | Example |
|-------------------------------------|-----------------------------|--------------|
| Steel ,Zinc plated chrome (VI)-free | | XSV06L |
| Steel ,Zinc nickel plated | ZiNi | XSV06L-ZINI |
| Stainless Steel-SS316 | SS316 | XSV06L-SS316 |
| Stainless Steel-SS304 | SS304 | XSV06L-SS304 |

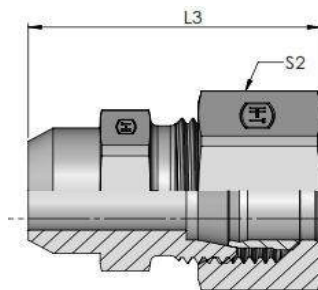
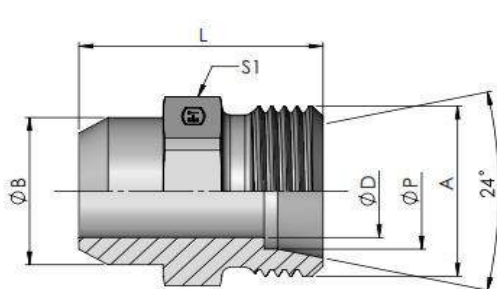

C-08

AS-Welding Connector

L SERIES

| Tube O.D. | A THREAD | S1 Hex | S2 Hex | L | ØB | ØD DRILL | ØP | L3 | Body Part Number | Assembly Part Number | Torque N-m | Working pressure in Bar |
|-----------|------------|--------|--------|-------|-------|----------|-------|-------|------------------|----------------------|------------|-------------------------|
| 6 | M12X1.5-6g | 12.00 | 14.00 | 21.00 | 10.00 | 4.00 | 6.00 | 29.00 | XAS06L | AS06L | 13-15 | 250 |
| 8 | M14X1.5-6g | 14.00 | 17.00 | 23.00 | 12.00 | 6.00 | 8.00 | 31.00 | XAS08L | AS08L | 15-18 | 250 |
| 10 | M16X1.5-6g | 17.00 | 19.00 | 25.00 | 14.00 | 8.00 | 10.00 | 33.00 | XAS10L | AS10L | 25-28 | 250 |
| 12 | M18X1.5-6g | 19.00 | 22.00 | 25.00 | 16.00 | 10.00 | 12.00 | 33.00 | XAS12L | AS12L | 27-30 | 250 |
| 15 | M22X1.5-6g | 22.00 | 27.00 | 29.00 | 19.00 | 12.00 | 15.00 | 37.00 | XAS15L | AS15L | 50-60 | 250 |
| 18 | M26X1.5-6g | 27.00 | 32.00 | 31.00 | 22.00 | 15.00 | 18.00 | 40.00 | XAS18L | AS18L | 60-75 | 160 |
| 22 | M30X2.0-6g | 32.00 | 36.00 | 36.00 | 27.00 | 19.00 | 22.00 | 45.00 | XAS22L | AS22L | 85-105 | 160 |
| 28 | M36X2.0-6g | 41.00 | 41.00 | 38.00 | 32.00 | 24.00 | 28.00 | 47.00 | XAS28L | AS28L | 120-140 | 100 |
| 35 | M45X2.0-6g | 46.00 | 50.00 | 43.00 | 40.00 | 30.00 | 35.00 | 54.00 | XAS35L | AS35L | 170-190 | 100 |
| 42 | M52X2.0-6g | 55.00 | 60.00 | 46.00 | 46.00 | 36.00 | 42.00 | 58.00 | XAS42L | AS42L | 190-230 | 100 |

S SERIES

| Tube O.D. | A THREAD | S1 Hex | S2 Hex | L | ØB | ØD DRILL | ØP | L3 | Body Part Number | Assembly Part Number | Torque N-m | Working pressure in Bar |
|-----------|------------|--------|--------|-------|-------|----------|-------|-------|------------------|----------------------|------------|-------------------------|
| 6 | M14X1.5-6g | 14.00 | 17.00 | 26.00 | 11.00 | 4.00 | 6.00 | 34.00 | XAS06S | AS06S | 14-16 | 630 |
| 8 | M16X1.5-6g | 17.00 | 19.00 | 28.00 | 13.00 | 5.00 | 8.00 | 36.00 | XAS08S | AS08S | 25-28 | 630 |
| 10 | M18X1.5-6g | 19.00 | 22.00 | 30.00 | 15.00 | 7.00 | 10.00 | 39.00 | XAS10S | AS10S | 27-30 | 630 |
| 12 | M20X1.5-6g | 22.00 | 24.00 | 32.00 | 17.00 | 8.00 | 12.00 | 41.00 | XAS12S | AS12S | 43-54 | 630 |
| 14 | M22X1.5-6g | 24.00 | 27.00 | 35.00 | 19.00 | 10.00 | 14.00 | 45.00 | XAS14S | AS14S | 50-62 | 630 |
| 16 | M24X1.5-6g | 27.00 | 30.00 | 35.00 | 21.00 | 12.00 | 16.00 | 45.00 | XAS16S | AS16S | 60-75 | 400 |
| 20 | M30X2.0-6g | 32.00 | 36.00 | 40.00 | 26.00 | 16.00 | 20.00 | 51.00 | XAS20S | AS20S | 90-110 | 400 |
| 25 | M36X2.0-6g | 41.00 | 46.00 | 44.00 | 31.00 | 20.00 | 25.00 | 56.00 | XAS25S | AS25S | 125-145 | 400 |
| 30 | M42X2.0-6g | 46.00 | 50.00 | 49.00 | 36.00 | 25.00 | 30.00 | 62.00 | XAS30S | AS30S | 170-190 | 250 |
| 38 | M52X2.0-6g | 55.00 | 60.00 | 54.00 | 44.00 | 32.00 | 38.00 | 69.00 | XAS38S | AS38S | 200-245 | 250 |

| Material | Suffix surface and material | Example |
|-------------------------------------|-----------------------------|--------------|
| Steel ,Zinc plated chrome (VI)-free | | XAS06L |
| Steel ,Zinc nickel plated | ZiNi | XAS06L-ZINI |
| Stainless Steel-SS316 | SS316 | XAS06L-SS316 |
| Stainless Steel-SS304 | SS304 | XAS06L-SS304 |

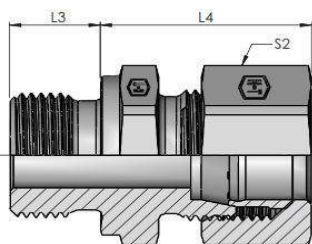
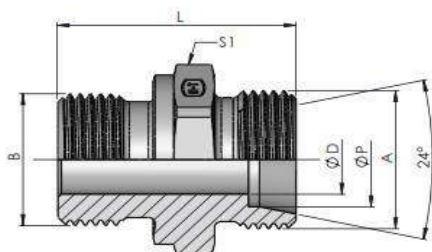

C-09

GE-R-Parallel Male Stud Coupling

L SERIES

| Tube O.D. | A THREAD | B THREAD | S1 Hex | S2 Hex | L | ØD DRILL | ØP | L3 | L4 | Body Part Number | Assembly Part Number | Torque N-m | Working pressure in Bar |
|-----------|------------|-------------------|--------|--------|-------|----------|-------|-------|-------|------------------|----------------------|------------|-------------------------|
| 6 | M12X1.5-6g | G1/8"-28-BSPP-A | 14.00 | 14.00 | 23.50 | 4.00 | 6.00 | 12.00 | 28.00 | XGE06LR | GE06LR | 13-15 | 250 |
| 8 | M14X1.5-6g | G1/4"-19-BSPP-A | 19.00 | 17.00 | 29.00 | 6.00 | 8.00 | 12.00 | 30.00 | XGE08LR | GE08LR | 15-18 | 250 |
| 10 | M16X1.5-6g | G1/4"-19-BSPP-A | 19.00 | 19.00 | 30.00 | 6.00 | 10.00 | 12.00 | 31.00 | XGE10LR | GE10LR | 25-28 | 250 |
| 12 | M18X1.5-6g | G3/8"-19-BSPP-A | 22.00 | 22.00 | 31.50 | 9.00 | 12.00 | 12.00 | 33.00 | XGE12LR | GE12LR | 27-30 | 250 |
| 15 | M22X1.5-6g | G1/2"-14-BSPP-A | 27.00 | 27.00 | 32.50 | 11.00 | 15.00 | 14.00 | 37.00 | XGE15LR | GE15LR | 50-60 | 250 |
| 18 | M26X1.5-6g | G1/2"-14-BSPP-A | 27.00 | 32.00 | 36.00 | 14.00 | 18.00 | 14.00 | 37.00 | XGE18LR | GE18LR | 60-75 | 160 |
| 22 | M30X2.0-6g | G3/4"-14-BSPP-A | 32.00 | 36.00 | 40.00 | 18.00 | 22.00 | 16.00 | 42.00 | XGE22LR | GE22LR | 85-105 | 160 |
| 28 | M36X2.0-6g | G1"-11-BSPP-A | 41.00 | 41.00 | 43.00 | 23.00 | 26.00 | 18.00 | 47.00 | XGE28LR | GE28LR | 120-140 | 100 |
| 35 | M45X2.0-6g | G1-1/4"-11-BSPP-A | 50.00 | 50.00 | 48.00 | 30.00 | 35.00 | 20.00 | 50.00 | XGE35LR | GE35LR | 170-190 | 100 |
| 42 | M52X2.0-6g | G1-1/2"-11-BSPP-A | 55.00 | 60.00 | 52.00 | 36.00 | 42.00 | 22.00 | 57.00 | XGE42LR | GE42LR | 190-230 | 100 |

S SERIES

| Tube O.D. | A THREAD | B THREAD | S1 Hex | S2 Hex | L | ØD DRILL | ØP | L3 | L4 | Body Part Number | Assembly Part Number | Torque N-m | Working pressure in Bar |
|-----------|------------|-------------------|--------|--------|-------|----------|-------|-------|-------|------------------|----------------------|------------|-------------------------|
| 6 | M14X1.5-6g | G1/4"-19-BSPP-A | 19.00 | 17.00 | 32.00 | 4.00 | 6.00 | 8.00 | 23.00 | XGE06SR | GE06SR | 14-16 | 630 |
| 8 | M16X1.5-6g | G1/4"-19-BSPP-A | 19.00 | 19.00 | 34.00 | 5.00 | 8.00 | 12.00 | 25.00 | XGE08SR | GE08SR | 25-28 | 630 |
| 10 | M18X1.5-6g | G3/8"-19-BSPP-A | 22.00 | 22.00 | 34.50 | 7.00 | 10.00 | 12.00 | 26.00 | XGE10SR | GE10SR | 27-30 | 630 |
| 12 | M20X1.5-6g | G3/8"-19-BSPP-A | 22.00 | 24.00 | 36.50 | 8.00 | 12.00 | 12.00 | 27.00 | XGE12SR | GE12SR | 43-54 | 630 |
| 14 | M22X1.5-6g | G1/2"-14-BSPP-A | 27.00 | 27.00 | 41.00 | 10.00 | 14.00 | 14.00 | 29.00 | XGE14SR | GE14SR | 50-62 | 630 |
| 16 | M24X1.5-6g | G1/2"-14-BSPP-A | 27.00 | 30.00 | 41.00 | 12.00 | 16.00 | 14.00 | 31.00 | XGE16SR | GE16SR | 60-75 | 400 |
| 20 | M30X2.0-6g | G3/4"-14-BSPP-A | 32.00 | 36.00 | 47.00 | 16.00 | 20.00 | 16.00 | 33.00 | XGE20SR | GE20SR | 90-110 | 400 |
| 25 | M36X2.0-6g | G1"-11-BSPP-A | 41.00 | 46.00 | 53.00 | 20.00 | 25.00 | 18.00 | 34.00 | XGE25SR | GE25SR | 125-145 | 400 |
| 30 | M42X2.0-6g | G1-1/4"-11-BSPP-A | 50.00 | 50.00 | 57.00 | 25.00 | 30.00 | 20.00 | 39.00 | XGE30SR | GE30SR | 170-190 | 250 |
| 38 | M52X2.0-6g | G1-1/2"-11-BSPP-A | 55.00 | 60.00 | 64.00 | 32.00 | 38.00 | 22.00 | 42.00 | XGE38SR | GE38SR | 200-245 | 250 |

| Material | Suffix surface and material | Example |
|-------------------------------------|-----------------------------|---------------|
| Steel ,Zinc plated chrome (VI)-free | | XGE06LR |
| Steel ,Zinc nickel plated | ZiNi | XGE06LR-ZINI |
| Stainless Steel-SS316 | SS316 | XGE06LR-SS316 |
| Stainless Steel-SS304 | SS304 | XGE06LR-SS304 |

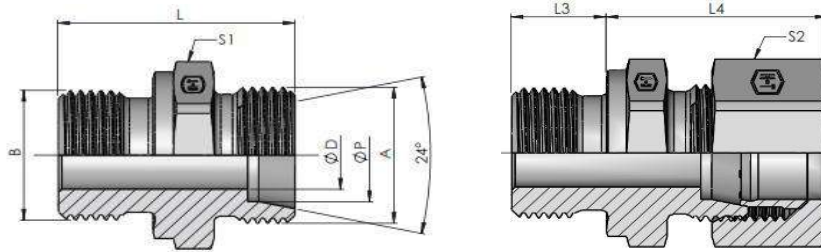

GE-M-Parallel Male Stud Coupling

L SERIES

| Tube O.D. | A THREAD | B THREAD | S1 Hex | S2 Hex | L | ØD DRILL | ØP | L3 | L4 | Body Part Number | Assembly Part Number | Torque N-m | Working pressure in Bar |
|-----------|------------|------------|--------|--------|-------|----------|-------|-------|-------|------------------|----------------------|------------|-------------------------|
| 6 | M12X1.5-6g | M10X1.0-6g | 14.00 | 14.00 | 23.50 | 4.00 | 6.00 | 8.00 | 23.00 | XGE06LM | GE06LM | 13-15 | 250 |
| 8 | M14X1.5-6g | M12X1.5-6g | 17.00 | 17.00 | 29.00 | 6.00 | 8.00 | 12.00 | 25.00 | XGE08LM | GE08LM | 15-18 | 250 |
| 10 | M16X1.5-6g | M14X1.5-6g | 19.00 | 19.00 | 30.00 | 7.00 | 10.00 | 12.00 | 26.00 | XGE10LM | GE10LM | 25-28 | 250 |
| 12 | M18X1.5-6g | M16X1.5-6g | 22.00 | 22.00 | 31.50 | 9.00 | 12.00 | 12.00 | 27.00 | XGE12LM | GE12LM | 27-30 | 250 |
| 15 | M22X1.5-6g | M18X1.5-6g | 24.00 | 27.00 | 32.50 | 11.00 | 15.00 | 12.00 | 29.00 | XGE15LM | GE15LM | 50-60 | 250 |
| 18 | M26X1.5-6g | M22X1.5-6g | 27.00 | 32.00 | 36.00 | 14.00 | 18.00 | 14.00 | 31.00 | XGE18LM | GE18LM | 60-75 | 160 |
| 22 | M30X2.0-6g | M26X1.5-6g | 32.00 | 36.00 | 40.00 | 18.00 | 22.00 | 16.00 | 33.00 | XGE22LM | GE22LM | 85-105 | 160 |
| 28 | M36X2.0-6g | M33X2.0-6g | 41.00 | 41.00 | 43.00 | 23.00 | 28.00 | 18.00 | 34.00 | XGE28LM | GE28LM | 120-140 | 100 |
| 35 | M45X2.0-6g | M42X2.0-6g | 50.00 | 50.00 | 48.00 | 30.00 | 35.00 | 20.00 | 39.00 | XGE35LM | GE35LM | 170-190 | 100 |
| 42 | M52X2.0-6g | M48X2.0-6g | 55.00 | 60.00 | 52.00 | 36.00 | 42.00 | 22.00 | 42.00 | XGE42LM | GE42LM | 190-230 | 100 |

S SERIES

| Tube O.D. | A THREAD | B THREAD | S1 Hex | S2 Hex | L | ØD DRILL | ØP | L3 | L4 | Body Part Number | Assembly Part Number | Torque N-m | Working pressure in Bar |
|-----------|------------|------------|--------|--------|-------|----------|-------|-------|-------|------------------|----------------------|------------|-------------------------|
| 6 | M14X1.5-6g | M12X1.5-6g | 17.00 | 17.00 | 32.00 | 4.00 | 6.00 | 12.00 | 28.00 | XGE06SM | GE06SM | 14-16 | 630 |
| 8 | M16X1.5-6g | M14X1.5-6g | 19.00 | 19.00 | 34.00 | 5.00 | 8.00 | 12.00 | 30.00 | XGE08SM | GE08SM | 25-28 | 630 |
| 10 | M18X1.5-6g | M16X1.5-6g | 22.00 | 22.00 | 34.50 | 7.00 | 10.00 | 12.00 | 31.00 | XGE10SM | GE10SM | 27-30 | 630 |
| 12 | M20X1.5-6g | M18X1.5-6g | 22.00 | 24.00 | 36.50 | 8.00 | 12.00 | 12.00 | 33.00 | XGE12SM | GE12SM | 43-54 | 630 |
| 14 | M22X1.5-6g | M20X1.5-6g | 27.00 | 27.00 | 41.00 | 10.00 | 14.00 | 14.00 | 37.00 | XGE14SM | GE14SM | 50-62 | 630 |
| 16 | M24X1.5-6g | M22X1.5-6g | 27.00 | 30.00 | 41.00 | 12.00 | 16.00 | 14.00 | 37.00 | XGE16SM | GE16SM | 60-75 | 400 |
| 20 | M30X2.0-6g | M27X2.0-6g | 32.00 | 36.00 | 47.00 | 16.00 | 20.00 | 16.00 | 42.00 | XGE20SM | GE20SM | 90-110 | 400 |
| 25 | M36X2.0-6g | M33X2.0-6g | 41.00 | 46.00 | 53.00 | 20.00 | 25.00 | 18.00 | 47.00 | XGE25SM | GE25SM | 125-145 | 400 |
| 30 | M42X2.0-6g | M42X2.0-6g | 50.00 | 50.00 | 57.00 | 25.00 | 30.00 | 20.00 | 50.00 | XGE30SM | GE30SM | 170-190 | 250 |
| 38 | M52X2.0-6g | M48X2.0-6g | 55.00 | 60.00 | 64.00 | 32.00 | 38.00 | 22.00 | 57.00 | XGE38SM | GE38SM | 200-245 | 250 |

| Material | Suffix surface and material | Example |
|-------------------------------------|-----------------------------|---------------|
| Steel ,Zinc plated chrome (VI)-free | | XGE06SM |
| Steel ,Zinc nickel plated | ZiNi | XGE06SM-ZiNi |
| Stainless Steel-SS316 | SS316 | XGE06SM-SS316 |
| Stainless Steel-SS304 | SS304 | XGE06SM-SS304 |

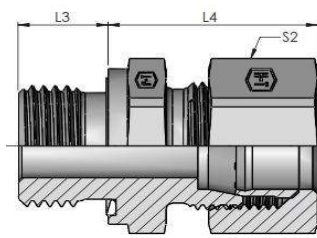
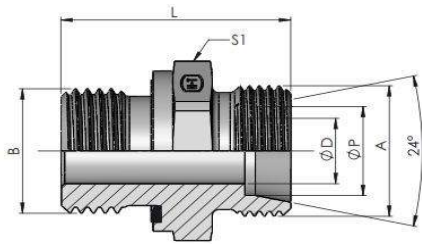

**GE-R-ED - Parallel Male Stud Coupling
L SERIES**

| Tube O.D. | A THREAD | B THREAD | S1 Hex | S2 Hex | L | ØD DRILL | ØP | L3 | L4 | Body Part Number | Assembly Part Number | Torque N-m | Working pressure in Bar |
|-----------|------------|-------------------|--------|--------|-------|----------|-------|-------|-------|------------------|----------------------|------------|-------------------------|
| 6 | M12X1.5-6g | G1/8"-28-BSPP-A | 14.00 | 14.00 | 23.50 | 4.00 | 6.00 | 8.00 | 23.00 | XGE06LRED | GE06LRED | 13-15 | 250 |
| 8 | M14X1.5-6g | G1/4"-19-BSPP-A | 19.00 | 17.00 | 29.00 | 6.00 | 8.00 | 12.00 | 25.00 | XGE08LRED | GE08LRED | 15-18 | 250 |
| 10 | M16X1.5-6g | G1/4"-19-BSPP-A | 19.00 | 19.00 | 30.00 | 6.00 | 10.00 | 12.00 | 26.00 | XGE10LRED | GE10LRED | 25-28 | 250 |
| 12 | M18X1.5-6g | G3/8"-19-BSPP-A | 22.00 | 22.00 | 31.50 | 9.00 | 12.00 | 12.00 | 27.00 | XGE12LRED | GE12LRED | 27-30 | 250 |
| 15 | M22X1.5-6g | G1/2"-14-BSPP-A | 27.00 | 27.00 | 35.00 | 11.00 | 15.00 | 14.00 | 29.00 | XGE15LRED | GE15LRED | 50-60 | 250 |
| 18 | M26X1.5-6g | G1/2"-14-BSPP-A | 27.00 | 32.00 | 36.00 | 14.00 | 18.00 | 14.00 | 31.00 | XGE18LRED | GE18LRED | 60-75 | 160 |
| 22 | M30X2.0-6g | G3/4"-14-BSPP-A | 32.00 | 36.00 | 40.00 | 18.00 | 22.00 | 16.00 | 33.00 | XGE22LRED | GE22LRED | 85-105 | 160 |
| 28 | M36X2.0-6g | G1"-11-BSPP-A | 41.00 | 41.00 | 43.00 | 23.00 | 28.00 | 18.00 | 34.00 | XGE28LRED | GE28LRED | 120-140 | 100 |
| 35 | M45X2.0-6g | G1-1/4"-11-BSPP-A | 50.00 | 50.00 | 48.00 | 30.00 | 35.30 | 20.00 | 39.00 | XGE35LRED | GE35LRED | 170-190 | 100 |
| 42 | M52X2.0-6g | G1-1/2"-11-BSPP-A | 55.00 | 60.00 | 52.00 | 36.00 | 42.30 | 22.00 | 42.00 | XGE42LRED | GE42LRED | 190-230 | 100 |

S SERIES

| Tube O.D. | A THREAD | B THREAD | S1 Hex | S2 Hex | L | ØD DRILL | ØP | L3 | L4 | Body Part Number | Assembly Part Number | Torque N-m | Working pressure in Bar |
|-----------|------------|-------------------|--------|--------|-------|----------|-------|-------|-------|------------------|----------------------|------------|-------------------------|
| 6 | M14X1.5-6g | G1/4"-19-BSPP-A | 19.00 | 17.00 | 32.00 | 4.00 | 6.00 | 12.00 | 28.00 | XGE06SRED | GE06SRED | 14-16 | 630 |
| 8 | M16X1.5-6g | G1/4"-19-BSPP-A | 19.00 | 19.00 | 34.00 | 5.00 | 8.00 | 12.00 | 30.00 | XGE08SRED | GE08SRED | 25-28 | 630 |
| 10 | M18X1.5-6g | G3/8"-19-BSPP-A | 22.00 | 22.00 | 34.50 | 7.00 | 10.00 | 12.00 | 31.00 | XGE10SRED | GE10SRED | 27-30 | 630 |
| 12 | M20X1.5-6g | G3/8"-19-BSPP-A | 22.00 | 24.00 | 36.50 | 8.00 | 12.00 | 12.00 | 33.00 | XGE12SRED | GE12SRED | 43-54 | 630 |
| 14 | M22X1.5-6g | G1/2"-14-BSPP-A | 27.00 | 27.00 | 41.00 | 10.00 | 14.00 | 14.00 | 37.00 | XGE14SRED | GE14SRED | 50-62 | 630 |
| 16 | M24X1.5-6g | G1/2"-14-BSPP-A | 27.00 | 30.00 | 41.00 | 12.00 | 16.00 | 14.00 | 37.00 | XGE16SRED | GE16SRED | 60-75 | 400 |
| 20 | M30X2.0-6g | G3/4"-14-BSPP-A | 32.00 | 36.00 | 47.00 | 16.00 | 20.00 | 14.00 | 42.00 | XGE20SRED | GE20SRED | 90-110 | 400 |
| 25 | M36X2.0-6g | G1"-11-BSPP-A | 41.00 | 46.00 | 53.00 | 20.00 | 25.00 | 18.00 | 47.00 | XGE25SRED | GE25SRED | 125-145 | 400 |
| 30 | M42X2.0-6g | G1-1/4"-11-BSPP-A | 50.00 | 50.00 | 57.00 | 25.00 | 30.00 | 20.00 | 50.00 | XGE30SRED | GE30SRED | 170-190 | 250 |
| 38 | M52X2.0-6g | G1-1/2"-11-BSPP-A | 55.00 | 60.00 | 64.00 | 32.00 | 38.00 | 22.00 | 57.00 | XGE38SRED | GE38SRED | 200-245 | 250 |

| Material | Suffix surface and material | Example |
|-------------------------------------|-----------------------------|-----------------|
| Steel ,Zinc plated chrome (VI)-free | | XGE06LRED |
| Steel ,Zinc nickel plated | ZiNi | XGE06LRED-ZINI |
| Stainless Steel-SS316 | SS316 | XGE06LRED-SS316 |
| Stainless Steel-SS304 | SS304 | XGE06LRED-SS304 |

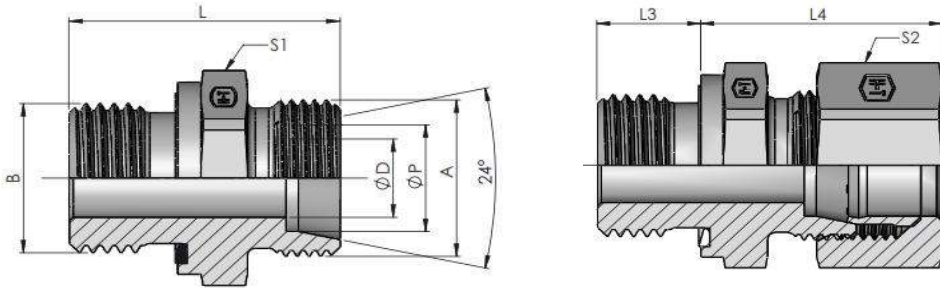

GE-M-ED - Parallel Male Stud Coupling

L SERIES

| Tube O.D. | A THREAD | B THREAD | S1 Hex | S2 Hex | L | ØD DRILL | ØP | L3 | L4 | Body Part Number | Assembly Part Number | Torque N-m | Working pressure in Bar |
|-----------|------------|------------|--------|--------|-------|----------|-------|-------|-------|------------------|----------------------|------------|-------------------------|
| 6 | M12X1.5-6g | M10X1.0-6g | 14.00 | 14.00 | 23.50 | 4.00 | 6.00 | 8.00 | 23.00 | XGE06LMED | GE06LMED | 13-15 | 250 |
| 8 | M14X1.5-6g | M12X1.5-6g | 17.00 | 17.00 | 29.00 | 6.00 | 8.00 | 12.00 | 25.00 | XGE08LMED | GE08LMED | 15-18 | 250 |
| 10 | M16X1.5-6g | M14X1.5-6g | 19.00 | 19.00 | 30.00 | 7.00 | 10.00 | 12.00 | 26.00 | XGE10LMED | GE10LMED | 25-28 | 250 |
| 12 | M18X1.5-6g | M16X1.5-6g | 22.00 | 22.00 | 31.50 | 9.00 | 12.00 | 12.00 | 27.00 | XGE12LMED | GE12LMED | 27-30 | 250 |
| 15 | M22X1.5-6g | M18X1.5-6g | 24.00 | 27.00 | 32.50 | 11.00 | 15.00 | 12.00 | 29.00 | XGE15LMED | GE15LMED | 50-60 | 250 |
| 18 | M26X1.5-6g | M22X1.5-6g | 27.00 | 32.00 | 36.00 | 14.00 | 18.00 | 14.00 | 31.00 | XGE18LMED | GE18LMED | 60-75 | 160 |
| 22 | M30X2.0-6g | M26X1.5-6g | 32.00 | 36.00 | 40.00 | 18.00 | 22.00 | 16.00 | 33.00 | XGE22LMED | GE22LMED | 85-105 | 160 |
| 28 | M36X2.0-6g | M33X2.0-6g | 41.00 | 41.00 | 43.00 | 23.00 | 28.00 | 18.00 | 34.00 | XGE28LMED | GE28LMED | 120-140 | 100 |
| 35 | M45X2.0-6g | M42X2.0-6g | 50.00 | 50.00 | 48.00 | 30.00 | 35.00 | 20.00 | 39.00 | XGE35LMED | GE35LMED | 170-190 | 100 |
| 42 | M52X2.0-6g | M48X2.0-6g | 55.00 | 60.00 | 52.00 | 36.00 | 42.00 | 22.00 | 42.00 | XGE42LMED | GE42LMED | 190-230 | 100 |

S SERIES

| Tube O.D. | A THREAD | B THREAD | S1 Hex | S2 Hex | L | ØD DRILL | ØP | L3 | L4 | BodyPartNumber | AssemblyPartNumber | Torque N-m | Working pressure in Bar |
|-----------|------------|------------|--------|--------|-------|----------|-------|-------|-------|----------------|--------------------|------------|-------------------------|
| 6 | M14X1.5-6g | M12X1.5-6g | 17.00 | 17.00 | 32.00 | 4.00 | 6.00 | 14.00 | 28.00 | XGE06SMED | GE06SMED | 14-16 | 630 |
| 8 | M16X1.5-6g | M14X1.5-6g | 19.00 | 19.00 | 34.00 | 5.00 | 8.00 | 12.00 | 30.00 | XGE08SMED | GE08SMED | 25-28 | 630 |
| 10 | M18X1.5-6g | M16X1.5-6g | 22.00 | 22.00 | 34.50 | 7.00 | 10.00 | 12.00 | 31.00 | XGE10SMED | GE10SMED | 27-30 | 630 |
| 12 | M20X1.5-6g | M18X1.5-6g | 24.00 | 24.00 | 36.50 | 8.00 | 12.00 | 12.00 | 33.00 | XGE12SMED | GE12SMED | 43-54 | 630 |
| 14 | M22X1.5-6g | M20X1.5-6g | 27.00 | 27.00 | 41.00 | 10.00 | 14.00 | 14.00 | 37.00 | XGE14SMED | GE14SMED | 50-62 | 630 |
| 16 | M24X1.5-6g | M22X1.5-6g | 27.00 | 30.00 | 41.00 | 12.00 | 16.00 | 14.00 | 37.00 | XGE16SMED | GE16SMED | 60-75 | 400 |
| 20 | M30X2.0-6g | M27X2.0-6g | 32.00 | 36.00 | 47.00 | 16.00 | 20.00 | 16.00 | 42.00 | XGE20SMED | GE20SMED | 90-110 | 400 |
| 25 | M36X2.0-6g | M33X2.0-6g | 41.00 | 46.00 | 53.00 | 20.00 | 25.00 | 18.00 | 47.00 | XGE25SMED | GE25SMED | 125-145 | 400 |
| 30 | M42X2.0-6g | M42X2.0-6g | 50.00 | 50.00 | 57.00 | 25.00 | 30.00 | 20.00 | 50.00 | XGE30SMED | GE30SMED | 170-190 | 250 |
| 38 | M52X2.0-6g | M48X2.0-6g | 55.00 | 60.00 | 64.00 | 32.00 | 38.00 | 22.00 | 57.00 | XGE38SMED | GE38SMED | 200-245 | 250 |

| Material | Suffix surface and material | Example |
|-------------------------------------|-----------------------------|-----------------|
| Steel ,Zinc plated chrome (VI)-free | | XGE06LMED |
| Steel ,Zinc nickel plated | ZiNi | XGE06LMED-ZINI |
| Stainless Steel-SS316 | SS316 | XGE06LMED-SS316 |
| Stainless Steel-SS304 | SS304 | XGE06LMED-SS304 |

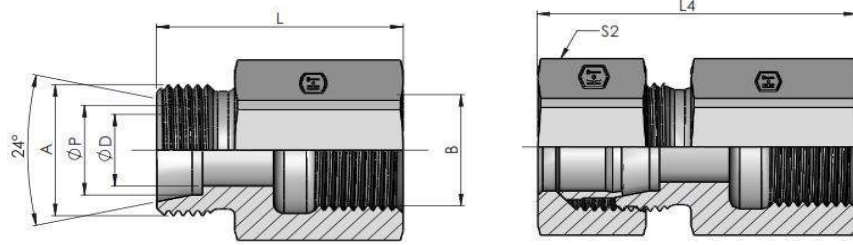

GAI-R - Parallel Female Coupling

L SERIES

| Tube O.D. | A THREAD | B THREAD | S1 Hex | S2 Hex | L | ØD DRILL | ØP | L4 | Body Part Number | Assembly Part Number | Torque N-m | Working pressure in Bar |
|-----------|------------|-------------------|--------|--------|-------|----------|-------|-------|------------------|----------------------|------------|-------------------------|
| 6 | M12X1.5-6g | G1/8"-28-BSPP-A | 14.00 | 14.00 | 26.00 | 4.00 | 6.00 | 34.00 | XGAI06LR | GAI06LR | 13-15 | 250 |
| 8 | M14X1.5-6g | G1/4"-19-BSPP-A | 19.00 | 17.00 | 31.00 | 6.00 | 8.00 | 39.00 | XGAI08LR | GAI08LR | 15-18 | 250 |
| 10 | M16X1.5-6g | G1/4"-19-BSPP-A | 19.00 | 19.00 | 32.00 | 6.00 | 10.00 | 40.00 | XGAI10LR | GAI10LR | 25-28 | 250 |
| 12 | M18X1.5-6g | G3/8"-19-BSPP-A | 24.00 | 22.00 | 33.00 | 9.00 | 12.00 | 41.00 | XGAI12LR | GAI12LR | 27-30 | 250 |
| 15 | M22X1.5-6g | G1/2"-14-BSPP-A | 27.00 | 27.00 | 38.00 | 11.00 | 15.00 | 46.00 | XGAI15LR | GAI15LR | 50-60 | 250 |
| 18 | M26X1.5-6g | G1/2"-14-BSPP-A | 27.00 | 32.00 | 38.00 | 14.00 | 18.00 | 47.00 | XGAI18LR | GAI18LR | 60-75 | 160 |
| 22 | M30X2.0-6g | G3/4"-14-BSPP-A | 36.00 | 36.00 | 43.00 | 18.00 | 22.00 | 52.00 | XGAI22LR | GAI22LR | 85-105 | 160 |
| 28 | M36X2.0-6g | G1"-11-BSPP-A | 41.00 | 41.00 | 45.50 | 23.00 | 28.00 | 55.00 | XGAI28LR | GAI28LR | 120-140 | 100 |
| 35 | M45X2.0-6g | G1-1/4"-11-BSPP-A | 55.00 | 50.00 | 51.50 | 30.00 | 35.00 | 63.00 | XGAI35LR | GAI35LR | 170-190 | 100 |
| 42 | M52X2.0-6g | G1-1/2"-11-BSPP-A | 60.00 | 60.00 | 53.50 | 36.00 | 42.00 | 65.00 | XGAI42LR | GAI42LR | 190-230 | 100 |

S SERIES

| Tube O.D. | A THREAD | B THREAD | S1 Hex | S2 Hex | L | ØD DRILL | ØP | L4 | Body Part Number | Assembly Part Number | Torque N-m | Working pressure in Bar |
|-----------|------------|-------------------|--------|--------|-------|----------|-------|-------|------------------|----------------------|------------|-------------------------|
| 6 | M14X1.5-6g | G1/4"-19-BSPP-A | 19.00 | 17.00 | 33.00 | 4.00 | 6.00 | 41.00 | XGAI06SR | GAI06SR | 14-16 | 630 |
| 8 | M16X1.5-6g | G1/4"-19-BSPP-A | 19.00 | 19.00 | 33.00 | 5.00 | 8.00 | 41.00 | XGAI08SR | GAI08SR | 25-28 | 630 |
| 10 | M18X1.5-6g | G3/8"-19-BSPP-A | 24.00 | 22.00 | 34.00 | 7.00 | 10.00 | 43.00 | XGAI10SR | GAI10SR | 27-30 | 630 |
| 12 | M20X1.5-6g | G3/8"-19-BSPP-A | 24.00 | 24.00 | 34.00 | 8.00 | 12.00 | 43.00 | XGAI12SR | GAI12SR | 43-54 | 630 |
| 16 | M24X1.5-6g | G1/2"-14-BSPP-A | 30.00 | 30.00 | 40.00 | 12.00 | 16.00 | 50.00 | XGAI16SR | GAI16SR | 60-75 | 400 |
| 20 | M30X2.0-6g | G3/4"-14-BSPP-A | 36.00 | 36.00 | 45.00 | 16.00 | 20.00 | 56.00 | XGAI20SR | GAI20SR | 90-110 | 400 |
| 25 | M36X2.0-6g | G1"-11-BSPP-A | 41.00 | 46.00 | 49.50 | 20.00 | 25.00 | 62.00 | XGAI25SR | GAI25SR | 125-145 | 400 |
| 30 | M42X2.0-6g | G1-1/4"-11-BSPP-A | 55.00 | 50.00 | 55.50 | 25.00 | 30.00 | 69.00 | XGAI30SR | GAI30SR | 170-190 | 250 |
| 38 | M52X2.0-6g | G1-1/2"-11-BSPP-A | 60.00 | 60.00 | 59.50 | 32.00 | 38.00 | 74.00 | XGAI38SR | GAI38SR | 200-245 | 250 |

| Material | Suffix surface and material | Example |
|-------------------------------------|-----------------------------|----------------|
| Steel ,Zinc plated chrome (VI)-free | | XGAI06LR |
| Steel ,Zinc nickel plated | ZiNi | XGAI06LR-ZINI |
| Stainless Steel-SS316 | SS316 | XGAI06LR-SS316 |
| Stainless Steel-SS304 | SS304 | XGAI06LR-SS304 |

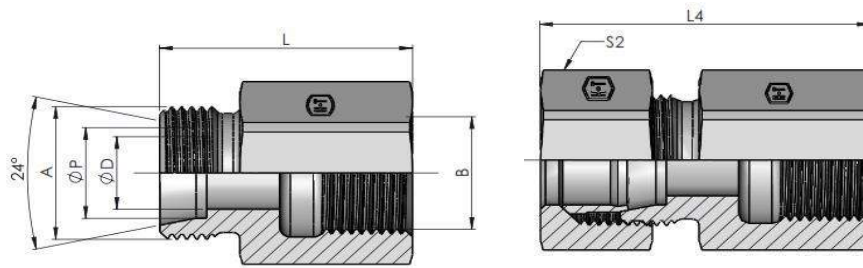

C-14

GAI-M - Parallel Female Coupling

L SERIES

| Tube O.D. | A THREAD | B THREAD | S1 Hex | S2 Hex | L | ØD DRILL | ØP | L4 | Body Part Number | Assembly Part Number | Torque N-m | Working pressure in Bar |
|-----------|------------|------------|--------|--------|-------|----------|-------|-------|------------------|----------------------|------------|-------------------------|
| 6 | M12X1.5-6g | M10X1.0-6H | 14.00 | 14.00 | 26.50 | 4.00 | 6.00 | 34.00 | XGAI06LM | GAI06LM | 13-15 | 250 |
| 8 | M14X1.5-6g | M12X1.5-6H | 17.00 | 17.00 | 31.00 | 6.00 | 8.00 | 34.00 | XGAI08LM | GAI08LM | 15-18 | 250 |
| 10 | M16X1.5-6g | M14X1.5-6H | 19.00 | 19.00 | 32.00 | 6.00 | 10.00 | 40.00 | XGAI10LM | GAI10LM | 25-28 | 250 |
| 12 | M18X1.5-6g | M16X1.5-6H | 22.00 | 22.00 | 33.00 | 9.00 | 12.00 | 41.00 | XGAI12LM | GAI12LM | 27-30 | 250 |
| 15 | M22X1.5-6g | M18X1.5-6H | 24.00 | 27.00 | 35.00 | 11.00 | 15.00 | 43.00 | XGAI15LM | GAI15LM | 50-60 | 250 |
| 18 | M26X1.5-6g | M22X1.5-6H | 27.00 | 32.00 | 37.00 | 14.00 | 18.00 | 46.00 | XGAI18LM | GAI18LM | 60-75 | 160 |
| 22 | M30X2.0-6g | M26X1.5-6H | 30.00 | 36.00 | 42.00 | 18.00 | 22.00 | 51.00 | XGAI22LM | GAI22LM | 85-105 | 160 |
| 28 | M36X2.0-6g | M33X2.0-6H | 41.00 | 41.00 | 45.00 | 23.00 | 28.00 | 54.00 | XGAI28LM | GAI28LM | 120-140 | 100 |
| 35 | M45X2.0-6g | M42X2.0-6H | 50.00 | 50.00 | 51.00 | 30.00 | 35.00 | 62.00 | XGAI35LM | GAI35LM | 170-190 | 100 |
| 42 | M52X2.0-6g | M48X2.0-6H | 55.00 | 60.00 | 53.00 | 36.00 | 42.00 | 65.00 | XGAI42LM | GAI42LM | 190-230 | 100 |

S SERIES

| Tube O.D. | A THREAD | B THREAD | S1 Hex | S2 Hex | L | ØD DRILL | ØP | L4 | Body Part Number | Assembly Part Number | Torque N-m | Working pressure in Bar |
|-----------|------------|------------|--------|--------|-------|----------|-------|-------|------------------|----------------------|------------|-------------------------|
| 6 | M14X1.5-6g | M12X1.5-6H | 17.00 | 17.00 | 33.00 | 4.00 | 6.00 | 41.00 | XGAI06SM | GAI06SM | 14-16 | 630 |
| 8 | M16X1.5-6g | M14X1.5-6H | 19.00 | 19.00 | 33.00 | 5.00 | 8.00 | 41.00 | XGAI08SM | GAI08SM | 25-28 | 630 |
| 10 | M18X1.5-6g | M16X1.5-6H | 22.00 | 22.00 | 34.00 | 7.00 | 10.00 | 43.00 | XGAI10SM | GAI10SM | 27-30 | 630 |
| 12 | M20X1.5-6g | M18X1.5-6H | 24.00 | 24.00 | 35.00 | 8.00 | 12.00 | 44.00 | XGAI12SM | GAI12SM | 43-54 | 630 |
| 16 | M24X1.5-6g | M22X1.5-6H | 30.00 | 30.00 | 39.00 | 12.00 | 16.00 | 49.00 | XGAI16SM | GAI16SM | 60-75 | 400 |
| 20 | M30X2.0-6g | M27X2.0-6H | 36.00 | 36.00 | 45.00 | 16.00 | 20.00 | 56.00 | XGAI20SM | GAI20SM | 90-110 | 400 |
| 25 | M36X2.0-6g | M33X2.0-6H | 41.00 | 46.00 | 49.00 | 20.00 | 25.00 | 61.00 | XGAI25SM | GAI25SM | 125-145 | 400 |
| 30 | M42X2.0-6g | M42X2.0-6H | 50.00 | 50.00 | 55.00 | 25.00 | 30.00 | 68.00 | XGAI30SM | GAI30SM | 170-190 | 250 |
| 38 | M52X2.0-6g | M48X2.0-6H | 55.00 | 60.00 | 59.00 | 32.00 | 38.00 | 74.00 | XGAI38SM | GAI38SM | 200-245 | 250 |

| Material | Suffix surface and material | Example |
|-------------------------------------|-----------------------------|----------------|
| Steel ,Zinc plated chrome (VI)-free | | XGAI06LM |
| Steel ,Zinc nickel plated | ZiNi | XGAI06LM-ZINI |
| Stainless Steel-SS316 | SS316 | XGAI06LM-SS316 |
| Stainless Steel-SS304 | SS304 | XGAI06LM-S304 |

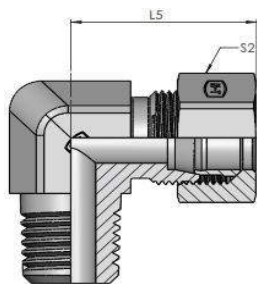
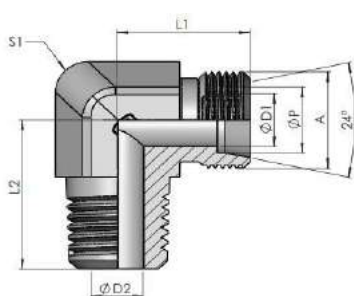

C-15

WE-R - Parallel Male Stud Coupling

L SERIES

| Tube O.D. | A THREAD | B THREAD | S1 Hex | S2 Hex | L1 | L2 | ØD1 DRILL | ØD2 DRILL | ØP | L5 | Body Part Number | Assembly Part Number | Torque N-m | Working pressure in Bar |
|-----------|------------|-------------------|--------|--------|-------|-------|-----------|-----------|-------|-------|------------------|----------------------|------------|-------------------------|
| 6 | M12X1.5-6g | R1/8"-28-BSPT-A | 12.00 | 14.00 | 19.00 | 20.00 | 4.00 | 4.00 | 6.0 | 27.00 | XWE06LR | WE06LR | 13-15 | 250 |
| 8 | M14X1.5-6g | R1/4"-19-BSPT-A | 14.00 | 17.00 | 21.00 | 26.00 | 6.00 | 6.00 | 8.00 | 29.00 | XWE08LR | WE08LR | 15-18 | 250 |
| 10 | M16X1.5-6g | R1/4"-19-BSPT-A | 14.00 | 19.00 | 22.00 | 27.00 | 7.00 | 7.00 | 10.00 | 30.00 | XWE10LR | WE10LR | 25-28 | 250 |
| 12 | M18X1.5-6g | R3/8"-19-BSPT-A | 17.00 | 22.00 | 24.00 | 28.00 | 9.00 | 9.00 | 12.00 | 32.00 | XWE12LR | WE12LR | 27-30 | 250 |
| 15 | M22X1.5-6g | R1/2"-14-BSPT-A | 24.00 | 27.00 | 28.00 | 34.00 | 11.00 | 11.00 | 15.00 | 36.00 | XWE15LR | WE15LR | 50-60 | 250 |
| 18 | M26X1.5-6g | R1/2"-14-BSPT-A | 24.00 | 32.00 | 31.00 | 36.00 | 14.00 | 14.00 | 18.00 | 40.00 | XWE18LR | WE18LR | 60-75 | 160 |
| 22 | M30X2.0-6g | G3/4"-14-BSPP-A | 27.00 | 36.00 | 35.00 | 42.00 | 18.00 | 18.00 | 22.00 | 44.00 | XWE22LR | WE22LR | 85-105 | 160 |
| 28 | M36X2.0-6g | G1"-11-BSPP-A | 36.00 | 41.00 | 38.00 | 48.00 | 23.00 | 23.00 | 28.00 | 47.00 | XWE28LR | WE28LR | 120-140 | 100 |
| 35 | M45X2.0-6g | G1-1/4"-11-BSPP-A | 41.00 | 50.00 | 45.00 | 54.00 | 30.00 | 30.00 | 35.00 | 56.00 | XWE35LR | WE35LR | 170-190 | 100 |
| 42 | M52X2.0-6g | G1-1/2"-11-BSPP-A | 50.00 | 60.00 | 51.00 | 61.00 | 36.00 | 36.00 | 42.00 | 63.00 | XWE42LR | WE42LR | 190-230 | 100 |

S SERIES

| Tube O.D. | A THREAD | B THREAD | S1 Hex | S2 Hex | L1 | L2 | ØD1 DRILL | ØD2 DRILL | ØP | L5 | Body Part Number | Assembly Part Number | Torque N-m | Working pressure in Bar |
|-----------|------------|-------------------|--------|--------|-------|-------|-----------|-----------|-------|-------|------------------|----------------------|------------|-------------------------|
| 6 | M14X1.5-6g | R1/4"-19-BSPT-A | 12.00 | 17.00 | 23.00 | 26.00 | 4.00 | 4.00 | 6.00 | 31.00 | XWE06SR | WE06SR | 14-16 | 630 |
| 8 | M16X1.5-6g | R1/4"-19-BSPT-A | 14.00 | 19.00 | 24.00 | 27.00 | 5.00 | 5.00 | 8.00 | 32.00 | XWE08SR | WE08SR | 25-28 | 630 |
| 10 | M18X1.5-6g | R3/8"-19-BSPT-A | 17.00 | 22.00 | 25.00 | 28.00 | 7.00 | 7.00 | 10.00 | 34.00 | XWE10SR | WE10SR | 27-30 | 630 |
| 12 | M20X1.5-6g | R3/8"-19-BSPT-A | 17.00 | 24.00 | 29.00 | 28.00 | 8.00 | 8.00 | 12.00 | 38.00 | XWE12SR | WE12SR | 43-54 | 630 |
| 16 | M24X1.5-6g | R1/2"-14-BSPT-A | 24.00 | 30.00 | 33.00 | 32.00 | 12.00 | 12.00 | 16.00 | 43.00 | XWE16SR | WE16SR | 60-75 | 400 |
| 20 | M30X2.0-6g | G3/4"-14-BSPP-A | 27.00 | 36.00 | 37.00 | 42.00 | 16.00 | 16.00 | 20.00 | 48.00 | XWE20SR | WE20SR | 90-110 | 400 |
| 25 | M36X2.0-6g | G1"-11-BSPP-A | 36.00 | 46.00 | 42.00 | 48.00 | 20.00 | 20.00 | 25.00 | 54.00 | XWE25SR | WE25SR | 125-145 | 400 |
| 30 | M42X2.0-6g | G1-1/4"-11-BSPP-A | 41.00 | 50.00 | 49.00 | 54.00 | 25.00 | 25.00 | 30.00 | 62.00 | XWE30SR | WE30SR | 170-190 | 250 |
| 38 | M52X2.0-6g | G1-1/2"-11-BSPP-A | 50.00 | 60.00 | 57.00 | 61.00 | 32.00 | 32.00 | 38.00 | 72.00 | XWE38SR | WE38SR | 200-245 | 250 |

| Material | Suffix surface and material | Example |
|-------------------------------------|-----------------------------|---------------|
| Steel ,Zinc plated chrome (VI)-free | | XWE06LR |
| Steel ,Zinc nickel plated | ZiNi | XWE06LR-ZINI |
| Stainless Steel-SS316 | SS316 | XWE06LR-SS316 |
| Stainless Steel-SS304 | SS304 | XWE06LR-SS304 |

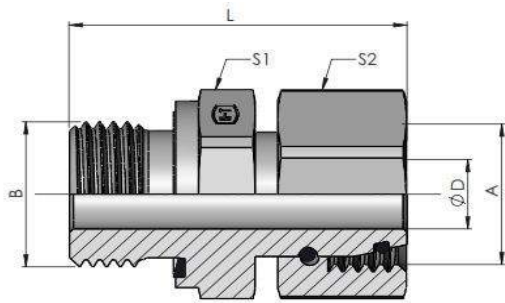

EGE-R-Swivel Connector

L SERIES

| Tube O.D. | A THREAD | B THREAD | S1 Hex | S2 Hex | L | ØD DRILL | Body Part Number | Assembly Part Number | Torque N-m | Working pressure in Bar |
|-----------|------------|------------------|--------|--------|-------|----------|------------------|----------------------|------------|-------------------------|
| 8 | M14X1.5-6H | G1/4"-19BSPP-A | 19.00 | 17.00 | 39.50 | 4.00 | XEGE08LRED | EGE08LRED | 15-18 | 250 |
| 10 | M16X1.5-6H | G1/4"-19BSPP-A | 19.00 | 19.00 | 38.00 | 6.00 | XEGE10LRED | EGE10LRED | 25-28 | 250 |
| 12 | M18X1.5-6H | G3/8"-19BSPP-A | 22.00 | 22.00 | 44.50 | 8.00 | XEGE12LRED | EGE12LRED | 27-30 | 250 |
| 15 | M22X1.5-6H | G1/2"-14BSPP-A | 27.00 | 27.00 | 44.50 | 10.00 | XEGE15LRED | EGE15LRED | 50-60 | 250 |
| 18 | M26X1.5-6H | G1/2"-14BSPP-A | 27.00 | 32.00 | 43.50 | 13.00 | XEGE18LRED | EGE18LRED | 60-75 | 160 |
| 22 | M30X2.0-6H | G3/4"-14BSPP-A | 32.00 | 36.00 | 46.50 | 17.00 | XEGE22LRED | EGE22LRED | 85-105 | 160 |
| 28 | M36X2.0-6H | G1"-11BSPP-A | 41.00 | 41.00 | 51.00 | 22.00 | XEGE28LRED | EGE28LRED | 120-140 | 100 |
| 35 | M45X2.0-6H | G1-1/4"-11BSPP-A | 50.00 | 50.00 | 59.00 | 28.00 | XEGE35LRED | EGE35LRED | 170-190 | 100 |
| 42 | M52X2.0-6H | G1-1/2"-11BSPP-A | 55.00 | 60.00 | 64.50 | 34.00 | XEGE42LRED | EGE42LRED | 190-230 | 100 |

S SERIES

| Tube O.D. | A THREAD | B THREAD | S1 Hex | S2 Hex | L | ØD DRILL | Body Part Number | Assembly Part Number | Torque N-m | Working pressure in Bar |
|-----------|------------|------------------|--------|--------|-------|----------|------------------|----------------------|------------|-------------------------|
| 8 | M16X1.5-6H | G1/4"-19BSPP-A | 19.00 | 19.00 | 39.50 | 4.00 | XEGE08SRED | EGE08SRED | 25-28 | 630 |
| 10 | M18X1.5-6H | G3/8"-19BSPP-A | 22.00 | 22.00 | 42.00 | 6.00 | XEGE10SRED | EGE10SRED | 27-30 | 630 |
| 12 | M20X1.5-6H | G3/8"-19BSPP-A | 22.00 | 24.00 | 44.00 | 8.00 | XEGE12SRED | EGE12SRED | 43-54 | 630 |
| 16 | M24X1.5-6H | G1/2"-14BSPP-A | 27.00 | 30.00 | 48.00 | 11.00 | XEGE16SRED | EGE16SRED | 60-75 | 400 |
| 20 | M30X2.0-6H | G3/4"-14BSPP-A | 32.00 | 36.00 | 55.50 | 14.00 | XEGE20SRED | EGE20SRED | 90-110 | 400 |
| 25 | M36X2.0-6H | G1"-11BSPP-A | 41.00 | 46.00 | 60.80 | 18.00 | XEGE25SRED | EGE25SRED | 125-145 | 400 |
| 30 | M42X2.0-6H | G1-1/4"-11BSPP-A | 50.00 | 50.00 | 64.50 | 23.00 | XEGE30SRED | EGE30SRED | 170-190 | 250 |
| 38 | M52X2.0-6H | G1-1/2"-11BSPP-A | 55.00 | 60.00 | 73.00 | 30.00 | XEGE38SRED | EGE38SRED | 200-245 | 250 |

| Material | Suffix surface and material | Example |
|-------------------------------------|-----------------------------|------------------|
| Steel ,Zinc plated chrome (VI)-free | | XEGE08LRED |
| Steel ,Zinc nickel plated | ZiNi | XEGE08LRED-ZiNi |
| Stainless Steel-SS316 | SS316 | XEGE08LRED-SS316 |
| Stainless Steel-SS304 | SS304 | XEGE08LRED-SS304 |

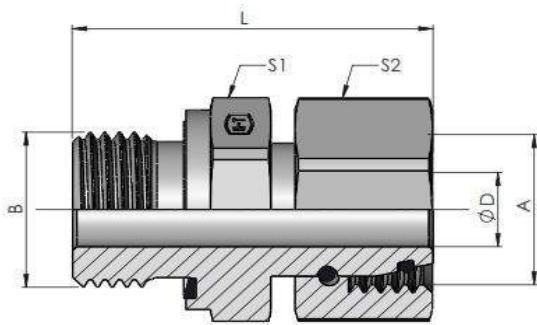

EGE-M-Swivel Connector

L SERIES

| Tube O.D. | A THREAD | B THREAD | S1 Hex | S2 Hex | L | ØD DRILL | Body Part Number | Assembly Part Number | Torque N-m | Working pressure in Bar |
|-----------|------------|------------|--------|--------|-------|----------|------------------|----------------------|------------|-------------------------|
| 8 | M14X1.5-6H | M12X1.5-6g | 17.00 | 17.00 | 38.50 | 4.00 | XEGE08LMED | EGE08LMED | 15-18 | 250 |
| 10 | M16X1.5-6H | M14X1.5-6g | 19.00 | 19.00 | 38.50 | 6.00 | XEGE10LMED | EGE10LMED | 25-28 | 250 |
| 12 | M18X1.5-6H | M16X1.5-6g | 22.00 | 22.00 | 41.00 | 7.50 | XEGE12LMED | EGE12LMED | 27-30 | 250 |
| 15 | M22X1.5-6H | M18X1.5-6g | 24.00 | 27.00 | 42.50 | 10.00 | XEGE15LMED | EGE15LMED | 50-60 | 250 |
| 18 | M26X1.5-6H | M22X1.5-6g | 27.00 | 32.00 | 44.20 | 14.00 | XEGE18LMED | EGE18LMED | 60-75 | 160 |
| 22 | M30X2.0-6H | M26X1.5-6g | 32.00 | 36.00 | 47.20 | 18.00 | XEGE22LMED | EGE22LMED | 85-105 | 160 |
| 28 | M36X2.0-6H | M33X2.0-6g | 41.00 | 41.00 | 52.00 | 22.00 | XEGE28LMED | EGE28LMED | 120-140 | 100 |
| 35 | M45X2.0-6H | M42X2.0-6g | 50.00 | 50.00 | 61.00 | 28.00 | XEGE35LMED | EGE35LMED | 170-190 | 100 |
| 42 | M52X2.0-6H | M48X2.0-6g | 50.00 | 60.00 | 66.30 | 36.00 | XEGE42LMED | EGE42LMED | 190-230 | 100 |

S SERIES

| Tube O.D. | A THREAD | B THREAD | S1 Hex | S2 Hex | L | ØD DRILL | Body Part Number | Assembly Part Number | Torque N-m | Working pressure in Bar |
|-----------|------------|------------|--------|--------|-------|----------|------------------|----------------------|------------|-------------------------|
| 8 | M16X1.5-6H | M14X1.5-6g | 19.00 | 19.00 | 40.20 | 4.00 | XEGE08SMED | EGE08SMED | 25-28 | 630 |
| 10 | M18X1.5-6H | M16X1.5-6g | 22.00 | 22.00 | 42.50 | 6.00 | XEGE10SMED | EGE10SMED | 27-30 | 630 |
| 12 | M20X1.5-6H | M18X1.5-6g | 24.00 | 24.00 | 44.70 | 8.00 | XEGE12SMED | EGE12SMED | 43-54 | 630 |
| 16 | M24X1.5-6H | M22X1.5-6g | 27.00 | 30.00 | 50.00 | 10.00 | XEGE16LMED | EGE16SMED | 60-75 | 400 |
| 20 | M30X2.0-6H | M27X2.0-6g | 32.00 | 36.00 | 58.00 | 14.00 | XEGE20SMED | EGE20SMED | 90-110 | 400 |
| 25 | M36X2.0-6H | M33X2.0-6g | 41.00 | 46.00 | 64.50 | 17.00 | XEGE25SMED | EGE25SMED | 125-145 | 400 |
| 30 | M42X2.0-6H | M42X2.0-6g | 50.00 | 50.00 | 69.50 | 22.00 | XEGE30SMED | EGE30SMED | 170-190 | 250 |
| 38 | M52X2.0-6H | M48X2.0-6g | 55.00 | 60.00 | 78.50 | 28.00 | XEGE38LMED | EGE38SMED | 200-245 | 250 |

| Material | Suffix surface and material | Example |
|-------------------------------------|-----------------------------|------------------|
| Steel ,Zinc plated chrome (VI)-free | | XEGE08LMED |
| Steel ,Zinc nickel plated | ZiNi | XEGE08LMED-ZINI |
| Stainless Steel-SS316 | SS316 | XEGE08LMED-SS316 |
| Stainless Steel-SS304 | SS304 | XEGE08LMED-SS304 |

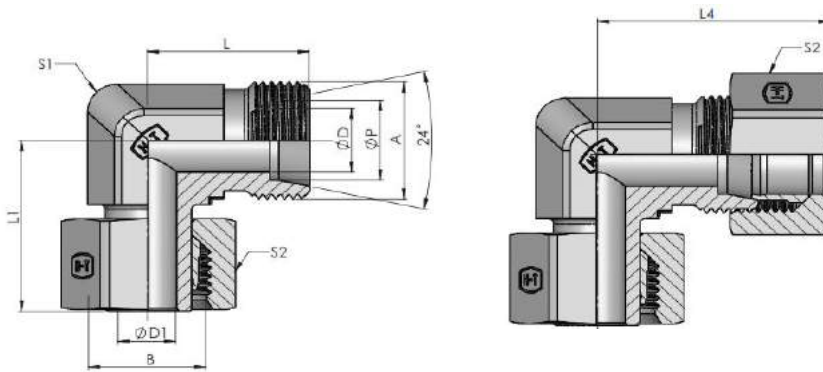

C-19

EVW-Swivel Elbow

L SERIES

| Tube O.D. | A THREAD | B THREAD | S1 Hex | S2 Hex | L | L1 | ØD DRILL | ØD1 DRILL | ØP | L4 | Body Part Number | Assembly Part Number | Torque N-m | Working pressure in Bar |
|-----------|------------|------------|--------|--------|-------|-------|----------|-----------|-------|-------|------------------|----------------------|------------|-------------------------|
| 6 | M12X1.5-6g | M12X1.5-6H | 12.00 | 14.00 | 19.00 | 26.00 | 4.00 | 3.00 | 6.00 | 27.00 | XEVW06L | EVW06L | 13-15 | 250 |
| 8 | M14X1.5-6g | M14X1.5-6H | 12.00 | 17.00 | 21.00 | 27.00 | 6.00 | 4.00 | 8.00 | 29.00 | XEVW08L | EVW08L | 15-18 | 250 |
| 10 | M16X1.5-6g | M16X1.5-6H | 14.00 | 19.00 | 22.00 | 28.50 | 8.00 | 6.00 | 10.00 | 30.00 | XEVW10L | EVW10L | 25-28 | 250 |
| 12 | M18X1.5-6g | M18X1.5-6H | 17.00 | 22.00 | 24.00 | 29.00 | 10.00 | 7.00 | 12.00 | 32.00 | XEVW12L | EVW12L | 27-30 | 250 |
| 15 | M22X1.5-6g | M22X1.5-6H | 19.00 | 27.00 | 28.00 | 32.00 | 12.00 | 10.00 | 15.00 | 36.00 | XEVW15L | EVW15L | 50-60 | 250 |
| 18 | M26X1.5-6g | M26X1.5-6H | 24.00 | 32.00 | 31.00 | 35.00 | 15.00 | 13.00 | 18.00 | 40.00 | XEVW18L | EVW18L | 60-75 | 160 |
| 22 | M30X2.0-6g | M30X2.0-6H | 27.00 | 36.00 | 35.00 | 38.00 | 19.00 | 16.00 | 22.00 | 44.00 | XEVW22L | EVW22L | 85-105 | 160 |
| 28 | M36X2.0-6g | M36X2.0-6H | 36.00 | 41.00 | 38.00 | 41.50 | 24.00 | 22.00 | 28.00 | 47.00 | XEVW28L | EVW28L | 120-140 | 100 |
| 35 | M45X2.0-6g | M45X2.0-6H | 41.00 | 50.00 | 45.00 | 51.00 | 30.00 | 28.00 | 35.00 | 56.00 | XEVW35L | EVW35L | 170-190 | 100 |
| 42 | M52X2.0-6g | M52X2.0-6H | 50.00 | 60.00 | 51.00 | 56.00 | 36.00 | 34.00 | 42.00 | 63.00 | XEVW42L | EVW42L | 190-230 | 100 |

S SERIES

| Tube O.D. | A THREAD | B THREAD | S1 Hex | S2 Hex | L | L1 | ØD DRILL | ØD1 DRILL | ØP | L4 | Body Part Number | Assembly Part Number | Torque N-m | Working pressure in Bar |
|-----------|------------|------------|--------|--------|-------|-------|----------|-----------|-------|-------|------------------|----------------------|------------|-------------------------|
| 6 | M14X1.5-6g | M14X1.5-6H | 12.00 | 17.00 | 23.00 | 27.00 | 4.00 | 3.00 | 6.00 | 31.00 | XEVW06S | EVW06S | 14-16 | 630 |
| 8 | M16X1.5-6g | M16X1.5-6H | 14.00 | 19.00 | 24.00 | 27.00 | 5.00 | 4.00 | 8.00 | 32.00 | XEVW08S | EVW08S | 25-28 | 630 |
| 10 | M18X1.5-6g | M18X1.5-6H | 17.00 | 22.00 | 25.00 | 29.50 | 7.00 | 6.00 | 10.00 | 34.00 | XEVW10S | EVW10S | 27-30 | 630 |
| 12 | M20X1.5-6g | M20X1.5-6H | 17.00 | 24.00 | 29.00 | 30.50 | 8.00 | 7.00 | 12.00 | 38.00 | XEVW12S | EVW12S | 43-54 | 630 |
| 14 | M22X1.5-6g | M22X1.5-6H | 19.00 | 27.00 | 30.00 | 34.50 | 10.00 | 9.00 | 14.00 | 40.00 | XEVW14S | EVW14S | 50-62 | 630 |
| 16 | M24X1.5-6g | M24X1.5-6H | 24.00 | 30.00 | 33.00 | 36.00 | 12.00 | 11.00 | 16.00 | 43.00 | XEVW16S | EVW16S | 60-75 | 400 |
| 20 | M30X2.0-6g | M30X2.0-6H | 27.00 | 36.00 | 37.00 | 44.00 | 16.00 | 15.00 | 20.00 | 48.00 | XEVW20S | EVW20S | 90-110 | 400 |
| 25 | M36X2.0-6g | M36X2.0-6H | 36.00 | 46.00 | 42.00 | 49.50 | 20.00 | 17.00 | 25.00 | 54.00 | XEVW25S | EVW25S | 125-145 | 400 |
| 30 | M42X2.0-6g | M42X2.0-6H | 41.00 | 50.00 | 49.00 | 55.00 | 25.00 | 22.00 | 30.00 | 62.00 | XEVW30S | EVW30S | 170-190 | 250 |
| 38 | M52X2.0-6g | M52X2.0-6H | 50.00 | 60.00 | 57.00 | 63.00 | 32.00 | 28.00 | 38.00 | 72.00 | XEVW38S | EVW38S | 200-245 | 250 |

| Material | Suffix surface and material | Example |
|-------------------------------------|-----------------------------|---------------|
| Steel ,Zinc plated chrome (VI)-free | | XEVW06L |
| Steel ,Zinc nickel plated | ZiNi | XEVW06L-ZINI |
| Stainless Steel-SS316 | SS316 | XEVW06L-SS316 |
| Stainless Steel-SS304 | SS304 | XEVW06L-SS304 |

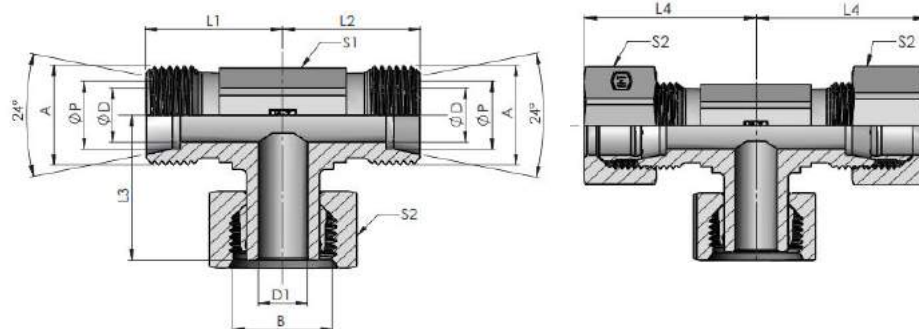

C-20

**EVW-Swivel Elbow
L SERIES**

| Tube O.D. | A THREAD | B THREAD | S1 Hex | S2 Hex | L1 L2 | L3 | ØD DRILL | ØD1 DRILL | ØP | L4 | Body Part Number | Assembly Part Number | Torque N-m | Working pressure in Bar |
|-----------|------------|------------|--------|--------|-------|-------|----------|-----------|-------|-------|------------------|----------------------|------------|-------------------------|
| 6 | M12X1.5-6g | M12X1.5-6H | 12.00 | 14.00 | 19.00 | 26.00 | 4.00 | 3.00 | 6.00 | 27.00 | XEVT06L | EVT06L | 13-15 | 250 |
| 8 | M14X1.5-6g | M14X1.5-6H | 14.00 | 17.00 | 21.00 | 27.00 | 6.00 | 4.00 | 8.00 | 29.00 | XEVT08L | EVT08L | 15-18 | 250 |
| 10 | M16X1.5-6g | M16X1.5-6H | 14.00 | 19.00 | 22.00 | 28.50 | 8.00 | 6.00 | 10.00 | 30.00 | XEVT10L | EVT10L | 25-28 | 250 |
| 12 | M18X1.5-6g | M18X1.5-6H | 17.00 | 22.00 | 24.00 | 29.00 | 10.00 | 7.00 | 12.00 | 32.00 | XEVT12L | EVT12L | 27-30 | 250 |
| 15 | M22X1.5-6g | M22X1.5-6H | 19.00 | 27.00 | 28.00 | 32.00 | 12.00 | 10.00 | 15.00 | 36.00 | XEVT15L | EVT15L | 50-60 | 250 |
| 18 | M26X1.5-6g | M26X1.5-6H | 24.00 | 32.00 | 31.00 | 35.00 | 15.00 | 13.00 | 18.00 | 40.00 | XEVT18L | EVT18L | 60-75 | 160 |
| 22 | M30X2.0-6g | M30X2.0-6H | 27.00 | 36.00 | 35.00 | 38.00 | 19.00 | 16.00 | 22.00 | 44.00 | XEVT22L | EVT22L | 85-105 | 160 |
| 28 | M36X2.0-6g | M36X2.0-6H | 36.00 | 41.00 | 38.00 | 41.50 | 24.00 | 22.00 | 28.00 | 47.00 | XEVT28L | EVT28L | 120-140 | 100 |
| 35 | M45X2.0-6g | M45X2.0-6H | 41.00 | 50.00 | 45.00 | 51.00 | 30.00 | 28.00 | 35.00 | 56.00 | XEVT35L | EVT35L | 170-190 | 100 |
| 42 | M52X2.0-6g | M52X2.0-6H | 50.00 | 60.00 | 51.00 | 56.00 | 36.00 | 34.00 | 42.00 | 63.00 | XEVT42L | EVT42L | 190-230 | 100 |

S SERIES

| Tube O.D. | A THREAD | B THREAD | S1 Hex | S2 Hex | L1 L2 | L3 | ØD DRILL | ØD1 DRILL | ØP | L4 | Body Part Number | Assembly Part Number | Torque N-m | Working pressure in Bar |
|-----------|------------|------------|--------|--------|-------|-------|----------|-----------|-------|-------|------------------|----------------------|------------|-------------------------|
| 6 | M14X1.5-6g | M14X1.5-6H | 14.00 | 17.00 | 23.00 | 27.00 | 4.00 | 3.00 | 6.00 | 31.00 | XEVT06S | EVT06S | 14-16 | 630 |
| 8 | M16X1.5-6g | M16X1.5-6H | 14.00 | 19.00 | 24.00 | 27.00 | 5.00 | 4.00 | 8.00 | 32.00 | XEVT08S | EVT08S | 25-28 | 630 |
| 10 | M18X1.5-6g | M18X1.5-6H | 17.00 | 22.00 | 25.00 | 29.50 | 7.00 | 6.00 | 10.00 | 34.00 | XEVT10S | EVT10S | 27-30 | 630 |
| 12 | M20X1.5-6g | M20X1.5-6H | 17.00 | 24.00 | 29.00 | 30.50 | 8.00 | 7.00 | 12.00 | 38.00 | XEVT12S | EVT12S | 43-54 | 630 |
| 14 | M22X1.5-6g | M22X1.5-6H | 24.00 | 27.00 | 30.00 | 34.50 | 10.00 | 9.00 | 14.00 | 40.00 | XEVT14S | EVT14S | 50-62 | 630 |
| 16 | M24X1.5-6g | M24X1.5-6H | 24.00 | 30.00 | 33.00 | 36.00 | 12.00 | 11.00 | 16.00 | 43.00 | XEVT16S | EVT16S | 60-75 | 400 |
| 20 | M30X2.0-6g | M30X2.0-6H | 27.00 | 36.00 | 37.00 | 44.00 | 16.00 | 15.00 | 20.00 | 48.00 | XEVT20S | EVT20S | 90-110 | 400 |
| 25 | M36X2.0-6g | M36X2.0-6H | 36.00 | 46.00 | 42.00 | 49.50 | 20.00 | 17.00 | 25.00 | 54.00 | XEVT25S | EVT25S | 125-145 | 400 |
| 30 | M42X2.0-6g | M42X2.0-6H | 41.00 | 50.00 | 49.00 | 55.00 | 25.00 | 22.00 | 30.00 | 62.00 | XEVT30S | EVT30S | 170-190 | 250 |
| 38 | M52X2.0-6g | M52X2.0-6H | 50.00 | 60.00 | 57.00 | 63.00 | 32.00 | 28.00 | 38.00 | 72.00 | XEVT38S | EVT38S | 200-245 | 250 |

| Material | Suffix surface and material | Example |
|-------------------------------------|-----------------------------|---------------|
| Steel ,Zinc plated chrome (VI)-free | | XEVT06L |
| Steel ,Zinc nickel plated | ZiNi | XEVT06L-ZiNi |
| Stainless Steel-SS316 | SS316 | XEVT06L-SS316 |
| Stainless Steel-SS304 | SS304 | XEVT06L-SS304 |

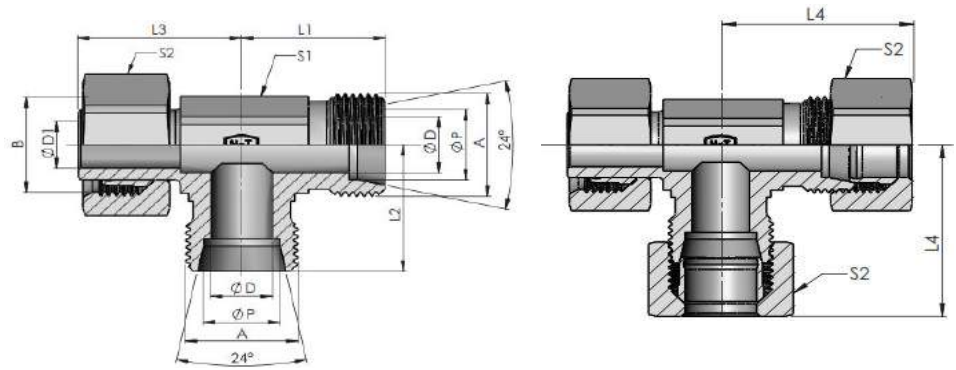

**EVL-Swivel Run Tee
L SERIES**

| Tube O.D. | A THREAD | B THREAD | S1 Hex | S2 Hex | L1 L2 | L3 | ØD DRILL | ØD1 DRILL | ØP | L4 | Body Part Number | Assembly Part Number | Torque N-m | Working pressure in Bar |
|-----------|------------|------------|--------|--------|-------|-------|----------|-----------|-------|-------|------------------|----------------------|------------|-------------------------|
| 6 | M12X1.5-6g | M12X1.5-6H | 12.00 | 14.00 | 19.00 | 26.00 | 4.00 | 3.00 | 6.00 | 27.00 | XEVL06L | EVL06L | 13-15 | 250 |
| 8 | M14X1.5-6g | M14X1.5-6H | 14.00 | 17.00 | 21.00 | 27.00 | 6.00 | 4.00 | 8.00 | 29.00 | XEVL08L | EVL08L | 15-18 | 250 |
| 10 | M16X1.5-6g | M16X1.5-6H | 14.00 | 19.00 | 22.00 | 28.50 | 8.00 | 6.00 | 10.00 | 30.00 | XEVL10L | EVL10L | 25-28 | 250 |
| 12 | M18X1.5-6g | M18X1.5-6H | 17.00 | 22.00 | 24.00 | 29.00 | 10.00 | 7.00 | 12.00 | 32.00 | XEVL12L | EVL12L | 27-30 | 250 |
| 15 | M22X1.5-6g | M22X1.5-6H | 19.00 | 27.00 | 28.00 | 32.00 | 12.00 | 10.00 | 15.00 | 36.00 | XEVL15L | EVL15L | 50-60 | 250 |
| 18 | M26X1.5-6g | M26X1.5-6H | 24.00 | 32.00 | 31.00 | 35.00 | 15.00 | 13.00 | 18.00 | 40.00 | XEVL18L | EVL18L | 60-75 | 160 |
| 22 | M30X2.0-6g | M30X2.0-6H | 27.00 | 36.00 | 35.00 | 38.00 | 19.00 | 16.00 | 22.00 | 44.00 | XEVL22L | EVL22L | 85-105 | 160 |
| 28 | M36X2.0-6g | M36X2.0-6H | 36.00 | 41.00 | 38.00 | 41.50 | 24.00 | 22.00 | 28.00 | 47.00 | XEVL28L | EVL28L | 120-140 | 100 |
| 35 | M45X2.0-6g | M45X2.0-6H | 41.00 | 50.00 | 45.00 | 51.00 | 30.00 | 28.00 | 35.00 | 56.00 | XEVL35L | EVL35L | 170-190 | 100 |
| 42 | M52X2.0-6g | M52X2.0-6H | 50.00 | 60.00 | 51.00 | 56.00 | 36.00 | 34.00 | 42.00 | 63.00 | XEVL42L | EVL42L | 190-230 | 100 |

S SERIES

| Tube O.D. | A THREAD | B THREAD | S1 Hex | S2 Hex | L1 L2 | L3 | ØD DRILL | ØD1 DRILL | ØP | L4 | Body Part Number | Assembly Part Number | Torque N-m | Working pressure in Bar |
|-----------|------------|------------|--------|--------|-------|-------|----------|-----------|-------|-------|------------------|----------------------|------------|-------------------------|
| 6 | M14X1.5-6g | M14X1.5-6H | 14.00 | 17.00 | 23.00 | 27.00 | 4.00 | 3.00 | 6.00 | 31.00 | XEVL06S | EVL06S | 14-16 | 630 |
| 8 | M16X1.5-6g | M16X1.5-6H | 14.00 | 19.00 | 24.00 | 27.00 | 5.00 | 4.00 | 8.00 | 32.00 | XEVL08S | EVL08S | 25-28 | 630 |
| 10 | M18X1.5-6g | M18X1.5-6H | 17.00 | 22.00 | 25.00 | 29.50 | 7.00 | 6.00 | 10.00 | 34.00 | XEVL10S | EVL10S | 27-30 | 630 |
| 12 | M20X1.5-6g | M20X1.5-6H | 17.00 | 24.00 | 29.00 | 30.50 | 8.00 | 7.00 | 12.00 | 38.00 | XEVL12S | EVL12S | 43-54 | 630 |
| 14 | M22X1.5-6g | M22X1.5-6H | 24.00 | 27.00 | 30.00 | 34.50 | 10.00 | 9.00 | 14.00 | 40.00 | XEVL14S | EVL14S | 50-62 | 630 |
| 16 | M24X1.5-6g | M24X1.5-6H | 24.00 | 30.00 | 33.00 | 36.00 | 12.00 | 11.00 | 16.00 | 43.00 | XEVL16S | EVL16S | 60-75 | 400 |
| 20 | M30X2.0-6g | M30X2.0-6H | 27.00 | 36.00 | 37.00 | 44.00 | 16.00 | 15.00 | 20.00 | 48.00 | XEVL20S | EVL20S | 90-110 | 400 |
| 25 | M36X2.0-6g | M36X2.0-6H | 36.00 | 46.00 | 42.00 | 49.50 | 20.00 | 17.00 | 25.00 | 54.00 | XEVL25S | EVL25S | 125-145 | 400 |
| 30 | M42X2.0-6g | M42X2.0-6H | 41.00 | 50.00 | 49.00 | 55.00 | 25.00 | 22.00 | 30.00 | 62.00 | XEVL30S | EVL30S | 170-190 | 250 |
| 38 | M52X2.0-6g | M52X2.0-6H | 50.00 | 60.00 | 57.00 | 63.00 | 32.00 | 28.00 | 38.00 | 72.00 | XEVL38S | EVL38S | 200-245 | 250 |

| Material | Suffix surface and material | Example |
|-------------------------------------|-----------------------------|---------------|
| Steel ,Zinc plated chrome (VI)-free | | XEVL06L |
| Steel ,Zinc nickel plated | ZiNi | XEVL06L-ZINI |
| Stainless Steel-SS316 | SS316 | XEVL06L-SS316 |
| Stainless Steel-SS304 | SS304 | XEVL06L-SS304 |

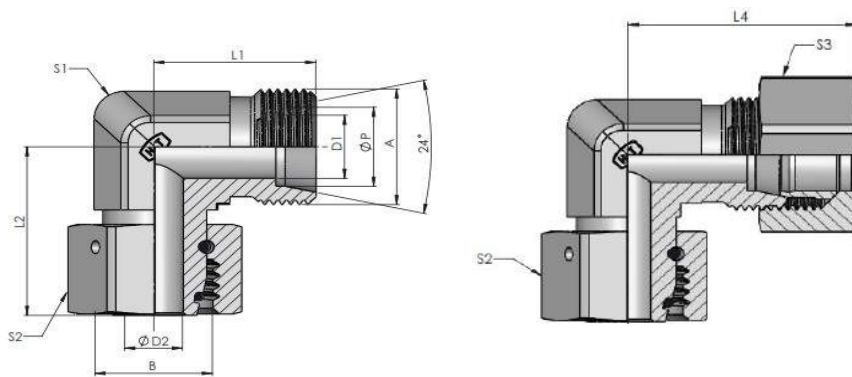

C-22

EW- Swivel Nut Elbow

L SERIES

| Tube O.D. | A THREAD | B THREAD | S1 Hex | S2 Hex | S3 Hex | L1 | L2 | ØD1 DRILL | ØD2 DRILL | ØP | L4 | Body Part Number | Assembly Part Number | Torque N-m | Working pressure in Bar |
|-----------|------------|------------|--------|--------|--------|-------|-------|-----------|-----------|-------|-------|------------------|----------------------|------------|-------------------------|
| 8 | M14X1.5-6g | M14X1.5-6H | 14.00 | 17.00 | 17.00 | 21.00 | 27.00 | 6.00 | 4.00 | 8.00 | 29.00 | XEW08L | EW08L | 15-18 | 250 |
| 10 | M16X1.5-6g | M16X1.5-6H | 14.00 | 19.00 | 19.00 | 22.00 | 28.50 | 8.00 | 6.00 | 10.00 | 30.00 | XEW10L | EW10L | 25-28 | 250 |
| 12 | M18X1.5-6g | M18X1.5-6H | 17.00 | 22.00 | 22.00 | 24.00 | 29.00 | 10.00 | 8.00 | 12.00 | 32.00 | XEW12L | EW12L | 27-30 | 250 |
| 15 | M22X1.5-6g | M22X1.5-6H | 19.00 | 27.00 | 27.00 | 28.00 | 32.00 | 12.00 | 10.00 | 15.00 | 36.00 | XEW15L | EW15L | 50-60 | 250 |
| 18 | M26X1.5-6g | M26X1.5-6H | 24.00 | 32.00 | 32.00 | 31.00 | 35.00 | 15.00 | 14.00 | 18.00 | 40.00 | XEW18L | EW18L | 60-75 | 160 |
| 22 | M30X2.0-6g | M30X2.0-6H | 27.00 | 36.00 | 36.00 | 35.00 | 38.00 | 19.00 | 18.00 | 22.00 | 44.00 | XEW22L | EW22L | 85-105 | 160 |
| 28 | M36X2.0-6g | M36X2.0-6H | 36.00 | 41.00 | 41.00 | 38.00 | 41.50 | 24.00 | 22.00 | 28.00 | 47.00 | XEW28L | EW28L | 120-140 | 100 |
| 35 | M45X2.0-6g | M45X2.0-6H | 41.00 | 50.00 | 50.00 | 45.00 | 51.00 | 30.00 | 28.00 | 35.00 | 56.00 | XEW35L | EW35L | 170-190 | 100 |
| 42 | M52X2.0-6g | M52X2.0-6H | 50.00 | 60.00 | 60.00 | 51.00 | 56.00 | 36.00 | 34.00 | 42.00 | 63.00 | XEW42L | EW42L | 190-230 | 100 |

S SERIES

| Tube O.D. | A THREAD | B THREAD | S1 Hex | S2 Hex | S3 Hex | L1 | L2 | ØD1 DRILL | ØD2 DRILL | ØP | L4 | Body Part Number | Assembly Part Number | Torque N-m | Working pressure in Bar |
|-----------|------------|------------|--------|--------|--------|-------|-------|-----------|-----------|-------|-------|------------------|----------------------|------------|-------------------------|
| 8 | M16X1.5-6g | M16X1.5-6H | 14.00 | 19.00 | 19.00 | 24.00 | 27.00 | 5.00 | 4.00 | 8.00 | 32.00 | XEW08S | EW08S | 25-28 | 630 |
| 10 | M18X1.5-6g | M18X1.5-6H | 17.00 | 22.00 | 22.00 | 25.00 | 29.50 | 7.00 | 6.00 | 10.00 | 34.00 | XEW10S | EW10S | 27-30 | 630 |
| 12 | M20X1.5-6g | M20X1.5-6H | 19.00 | 24.00 | 24.00 | 29.00 | 30.50 | 8.00 | 8.00 | 12.00 | 38.00 | XEW12S | EW12S | 43-54 | 630 |
| 16 | M24X1.5-6g | M24X1.5-6H | 24.00 | 30.00 | 30.00 | 33.00 | 36.00 | 12.00 | 11.00 | 16.00 | 43.00 | XEW16S | EW16S | 60-75 | 400 |
| 20 | M30X2.0-6g | M30X2.0-6H | 27.00 | 36.00 | 36.00 | 37.00 | 44.00 | 16.00 | 14.00 | 20.00 | 48.00 | XEW20S | EW20S | 90-110 | 400 |
| 25 | M36X2.0-6g | M36X2.0-6H | 36.00 | 46.00 | 46.00 | 42.00 | 49.50 | 20.00 | 18.00 | 25.00 | 54.00 | XEW25S | EW25S | 125-145 | 400 |
| 30 | M42X2.0-6g | M42X2.0-6H | 41.00 | 50.00 | 50.00 | 49.00 | 55.00 | 25.00 | 23.00 | 30.00 | 62.00 | XEW30S | EW30S | 170-190 | 250 |
| 38 | M52X2.0-6g | M52X2.0-6H | 50.00 | 60.00 | 60.00 | 57.00 | 63.00 | 32.00 | 30.00 | 38.00 | 72.00 | XEW38S | EW38S | 200-245 | 250 |

| Material | Suffix surface and material | Example |
|-------------------------------------|-----------------------------|--------------|
| Steel ,Zinc plated chrome (VI)-free | | XEW08L |
| Steel ,Zinc nickel plated | ZiNi | XEW08L-ZINI |
| Stainless Steel-SS316 | SS316 | XEW08L-SS316 |
| Stainless Steel-SS304 | SS304 | XEW08L-SS304 |

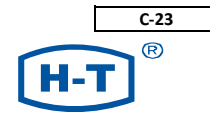
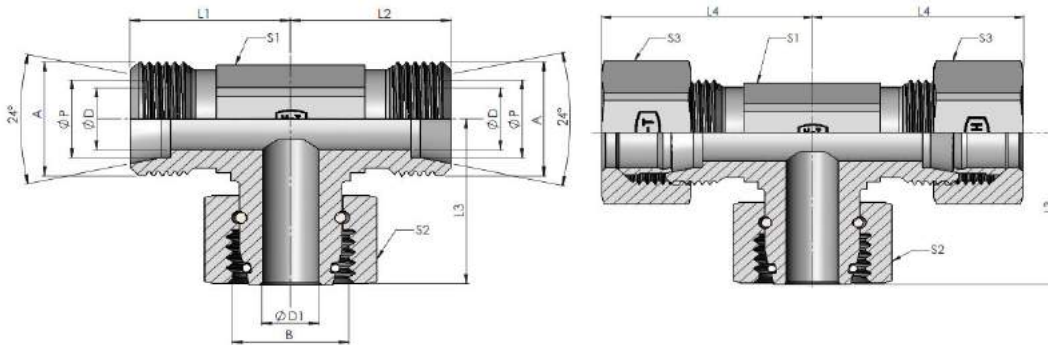

ET- Swivel Nut Branch Tee

L SERIES

| Tube O.D. | A THREAD | B THREAD | S1 Hex | S2 Hex | S3 Hex | L1 L2 | L3 | L4 | ØD | ØD1 | ØP | Body Part Number | Assembly Part Number | Torque N-m | Working pressure in Bar |
|-----------|------------|------------|--------|--------|--------|-------|-------|-------|-------|-------|-------|------------------|----------------------|------------|-------------------------|
| 8 | M14X1.5-6g | M14X1.5-6H | 14.00 | 17.00 | 17.00 | 21.00 | 27.00 | 29.00 | 6.00 | 4.00 | 8.00 | XET08L | ET08L | 14-18 | 250 |
| 10 | M16X1.5-6g | M16X1.5-6H | 14.00 | 19.00 | 19.00 | 22.00 | 28.50 | 30.00 | 8.00 | 6.00 | 10.00 | XET10L | ET10L | 23-27 | 250 |
| 12 | M18X1.5-6g | M18X1.5-6H | 17.00 | 22.00 | 22.00 | 24.00 | 29.00 | 32.00 | 10.00 | 8.00 | 12.00 | XET12L | ET12L | 29-34 | 250 |
| 15 | M22X1.5-6g | M22X1.5-6H | 19.00 | 27.00 | 27.00 | 28.00 | 32.00 | 36.00 | 12.00 | 10.00 | 15.00 | XET15L | ET15L | 38-42 | 250 |
| 18 | M26X1.5-6g | M26X1.5-6H | 24.00 | 32.00 | 32.00 | 31.00 | 35.00 | 40.00 | 15.00 | 14.00 | 18.00 | XET18L | ET18L | 48-52 | 160 |
| 22 | M30X2.0-6g | M30X2.0-6H | 27.00 | 36.00 | 36.00 | 35.00 | 38.00 | 44.00 | 19.00 | 18.00 | 22.00 | XET22L | ET22L | 75-80 | 160 |
| 28 | M36X2.0-6g | M36X2.0-6H | 36.00 | 41.00 | 41.00 | 38.00 | 41.50 | 47.00 | 24.00 | 22.00 | 28.00 | XET28L | ET28L | 110-120 | 100 |
| 35 | M45X2.0-6g | M45X2.0-6H | 41.00 | 50.00 | 50.00 | 45.00 | 51.00 | 56.00 | 30.00 | 28.00 | 35.00 | XET35L | ET35L | 150-160 | 100 |
| 42 | M52X2.0-6g | M52X2.0-6H | 50.00 | 60.00 | 60.00 | 51.00 | 56.00 | 63.00 | 36.00 | 34.00 | 42.00 | XET42L | ET42L | 150-160 | 100 |

S SERIES

| Tube O.D. | A THREAD | B THREAD | S1 Hex | S2 Hex | S3 Hex | L1 L2 | L3 | L4 | ØD | ØD1 | ØP | Body Part Number | Assembly Part Number | Torque N-m | Working pressure in Bar |
|-----------|------------|------------|--------|--------|--------|-------|-------|-------|-------|-------|-------|------------------|----------------------|------------|-------------------------|
| 8 | M16X1.5-6g | M16X1.5-6H | 14.00 | 19.00 | 19.00 | 24.00 | 27.00 | 32.00 | 5.00 | 4.00 | 8.00 | XET08S | ET08S | 38-42 | 400 |
| 10 | M18X1.5-6g | M18X1.5-6H | 17.00 | 22.00 | 22.00 | 25.00 | 29.50 | 34.00 | 7.00 | 6.00 | 10.00 | XET10S | ET10S | 47-53 | 400 |
| 12 | M20X1.5-6g | M20X1.5-6H | 17.00 | 24.00 | 24.00 | 29.00 | 30.50 | 38.00 | 8.00 | 8.00 | 12.00 | XET12S | ET12S | 57-63 | 400 |
| 16 | M24X1.5-6g | M24X1.5-6H | 24.00 | 30.00 | 30.00 | 33.00 | 36.00 | 43.00 | 12.00 | 11.00 | 16.00 | XET16S | ET16S | 80-90 | 400 |
| 20 | M30X2.0-6g | M30X2.0-6H | 27.00 | 36.00 | 36.00 | 37.00 | 44.00 | 48.00 | 16.00 | 14.00 | 20.00 | XET20S | ET20S | 133-147 | 400 |
| 25 | M36X2.0-6g | M36X2.0-6H | 36.00 | 46.00 | 46.00 | 42.00 | 49.50 | 54.00 | 20.00 | 18.00 | 25.00 | XET25S | ET25S | 180-200 | 400 |
| 30 | M42X2.0-6g | M42X2.0-6H | 41.00 | 50.00 | 50.00 | 49.00 | 55.00 | 62.00 | 25.00 | 23.00 | 30.00 | XET30S | ET30S | 257-283 | 250 |
| 38 | M52X2.0-6g | M52X2.0-6H | 50.00 | 60.00 | 60.00 | 57.00 | 63.00 | 72.00 | 32.00 | 30.00 | 38.00 | XET38S | ET38S | 257-283 | 250 |

| Material | Suffix surface and material | Example |
|-------------------------------------|-----------------------------|--------------|
| Steel ,Zinc plated chrome (VI)-free | | XET08L |
| Steel ,Zinc nickel plated | ZiNi | XET08L-ZINI |
| Stainless Steel-SS316 | SS316 | XET08L-SS316 |
| Stainless Steel-SS304 | SS304 | XET08L-SS304 |

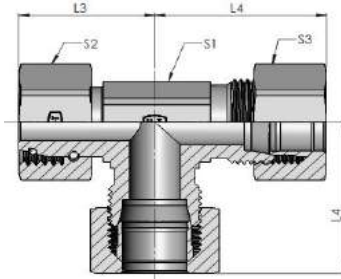
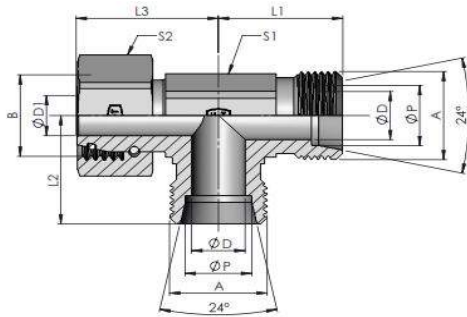

**EL- Swivel Nut run tee
L SERIES**

| Tube O.D. | A THREAD | B THREAD | S1 Hex | S2 Hex | S3 Hex | L1 L2 | L3 | L4 | ØD | ØD1 | ØP | Body Part Number | Assembly Part Number | Torque N-m | Working pressure in Bar |
|-----------|------------|------------|--------|--------|--------|-------|-------|-------|-------|-------|-------|------------------|----------------------|------------|-------------------------|
| 8 | M14X1.5-6g | M14X1.5-6H | 14.00 | 17.00 | 17.00 | 21.00 | 27.00 | 29.00 | 6.00 | 4.00 | 8.00 | XEL08L | EL08L | 14-18 | 250 |
| 10 | M16X1.5-6g | M16X1.5-6H | 14.00 | 19.00 | 19.00 | 22.00 | 28.50 | 30.00 | 8.00 | 6.00 | 10.00 | XEL10L | EL10L | 23-27 | 250 |
| 12 | M18X1.5-6g | M18X1.5-6H | 17.00 | 22.00 | 22.00 | 24.00 | 29.00 | 32.00 | 10.00 | 8.00 | 12.00 | XEL12L | EL12L | 29-34 | 250 |
| 15 | M22X1.5-6g | M22X1.5-6H | 19.00 | 27.00 | 27.00 | 28.00 | 32.00 | 36.00 | 12.00 | 10.00 | 15.00 | XEL15L | EL15L | 38-42 | 250 |
| 18 | M26X1.5-6g | M26X1.5-6H | 24.00 | 32.00 | 32.00 | 31.00 | 35.00 | 40.00 | 15.00 | 14.00 | 18.00 | XEL18L | EL18L | 48-52 | 160 |
| 22 | M30X2.0-6g | M30X2.0-6H | 27.00 | 36.00 | 36.00 | 35.00 | 38.00 | 44.00 | 19.00 | 18.00 | 22.00 | XEL22L | EL22L | 75-80 | 160 |
| 28 | M36X2.0-6g | M36X2.0-6H | 36.00 | 41.00 | 41.00 | 38.00 | 41.50 | 47.00 | 24.00 | 22.00 | 28.00 | XEL28L | EL28L | 110-120 | 100 |
| 35 | M45X2.0-6g | M45X2.0-6H | 41.00 | 50.00 | 50.00 | 45.00 | 51.00 | 56.00 | 30.00 | 28.00 | 35.00 | XEL35L | EL35L | 150-160 | 100 |
| 42 | M52X2.0-6g | M52X2.0-6H | 50.00 | 60.00 | 60.00 | 51.00 | 56.00 | 63.00 | 36.00 | 34.00 | 42.00 | XEL42L | EL42L | 150-160 | 100 |

S SERIES

| Tube O.D. | A THREAD | B THREAD | S1 Hex | S2 Hex | S3 Hex | L1 L2 | L3 | L4 | ØD | ØD1 | ØP | Body Part Number | Assembly Part Number | Torque N-m | Working pressure in Bar |
|-----------|------------|------------|--------|--------|--------|-------|-------|-------|------|-------|-------|------------------|----------------------|------------|-------------------------|
| 8 | M16X1.5-6g | M16X1.5-6H | 14.00 | 19.00 | 19.00 | 24.00 | 27.00 | 32.00 | 5.0 | 4.00 | 8.00 | XEL08S | EL08S | 38-42 | 400 |
| 10 | M18X1.5-6g | M18X1.5-6H | 17.00 | 22.00 | 22.00 | 25.00 | 29.50 | 34.00 | 7.0 | 6.00 | 10.00 | XEL10S | EL10S | 47-53 | 400 |
| 12 | M20X1.5-6g | M20X1.5-6H | 17.00 | 24.00 | 24.00 | 29.00 | 30.50 | 38.00 | 8.0 | 8.00 | 12.00 | XEL12S | EL12S | 57-63 | 400 |
| 16 | M24X1.5-6g | M24X1.5-6H | 24.00 | 30.00 | 30.00 | 33.00 | 36.00 | 43.00 | 12.0 | 11.00 | 16.00 | XEL16S | EL16S | 80-90 | 400 |
| 20 | M30X2.0-6g | M30X2.0-6H | 27.00 | 36.00 | 36.00 | 37.00 | 44.00 | 48.00 | 16.0 | 14.00 | 20.00 | XEL20S | EL20S | 133-147 | 400 |
| 25 | M36X2.0-6g | M36X2.0-6H | 36.00 | 46.00 | 46.00 | 42.00 | 49.50 | 54.00 | 20.0 | 18.00 | 25.00 | XEL25S | EL25S | 180-200 | 400 |
| 30 | M42X2.0-6g | M42X2.0-6H | 41.00 | 50.00 | 50.00 | 49.00 | 55.0 | 62.00 | 25.0 | 23.00 | 30.00 | XEL30S | EL30S | 257-283 | 250 |
| 38 | M52X2.0-6g | M52X2.0-6H | 50.00 | 60.00 | 60.00 | 57.00 | 63.0 | 72.00 | 32.0 | 30.00 | 38.00 | XEL38S | EL38S | 257-283 | 250 |

| Material | Suffix surface and material | Example |
|-------------------------------------|-----------------------------|--------------|
| Steel ,Zinc plated chrome (VI)-free | | XEL08L |
| Steel ,Zinc nickel plated | ZiNi | XEL08L-ZiNi |
| Stainless Steel-SS316 | SS316 | XEL08L-SS316 |
| Stainless Steel-SS304 | SS304 | XEL08L-SS304 |

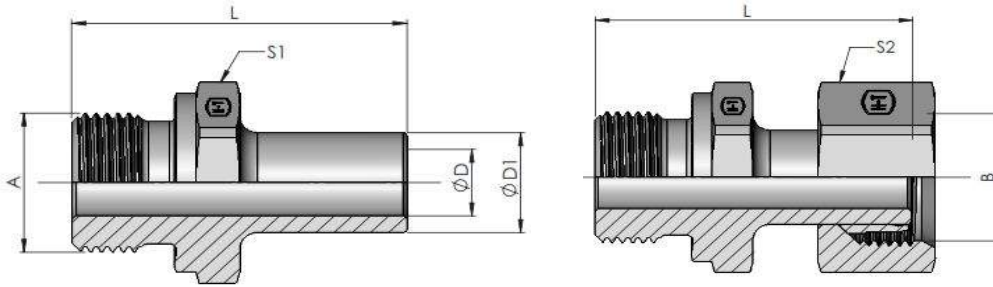

**EVGE-R Stand Pipe Adaptor with nut and ferrule
L SERIES**

| Tube O.D. | A THREAD | B THREAD | S1 Hex | S2 Hex | L | ØD DRILL | ØD1 | Body Part Number | Assembly Part Number | Torque N-m | Working pressure in Bar |
|-----------|-------------------|------------|--------|--------|-------|----------|-------|------------------|----------------------|------------|-------------------------|
| 6 | G1/8"-28-BSPP-A | M12X1.5-6H | 14.00 | 14.00 | 32.50 | 3.00 | 6.00 | XSP06LR | EVGE06LR | 13-15 | 250 |
| 8 | G1/4"-19-BSPP-A | M14X1.5-6H | 19.00 | 17.00 | 41.50 | 4.00 | 8.00 | XSP08LR | EVGE08LR | 15-18 | 250 |
| 10 | G1/4"-19-BSPP-A | M16X1.5-6H | 19.00 | 19.00 | 39.50 | 6.00 | 10.00 | XSP10LR | EVGE10LR | 25-28 | 250 |
| 12 | G3/8"-19-BSPP-A | M18X1.5-6H | 22.00 | 22.00 | 46.00 | 7.00 | 12.00 | XSP12LR | EVGE12LR | 27-30 | 250 |
| 15 | G1/2"-14-BSPP-A | M22X1.5-6H | 27.00 | 27.00 | 46.00 | 10.00 | 15.00 | XSP15LR | EVGE15LR | 50-60 | 250 |
| 18 | G1/2"-14-BSPP-A | M26X1.5-6H | 27.00 | 32.00 | 45.50 | 13.00 | 18.00 | XSP18LR | EVGE18LR | 60-75 | 160 |
| 22 | G3/4"-14-BSPP-A | M30X2.0-6H | 32.00 | 36.00 | 48.50 | 16.00 | 22.00 | XSP22LR | EVGE22LR | 85-105 | 160 |
| 28 | G1"-11-BSPP-A | M36X2.0-6H | 41.00 | 41.00 | 53.00 | 22.00 | 28.00 | XSP28LR | EVGE28LR | 120-140 | 100 |
| 35 | G1-1/4"-11-BSPP-A | M45X2.0-6H | 50.00 | 50.00 | 62.50 | 28.00 | 35.00 | XSP35LR | EVGE35LR | 170-190 | 100 |
| 42 | G1-1/2"-11-BSPP-A | M52X2.0-6H | 55.00 | 60.00 | 68.50 | 34.00 | 42.00 | XSP42LR | EVGE42LR | 190-230 | 100 |

S SERIES

| Tube O.D. | A THREAD | B THREAD | S1 Hex | S2 Hex | L | ØD DRILL | ØD1 | Body Part Number | Assembly Part Number | Torque N-m | Working pressure in Bar |
|-----------|-------------------|------------|--------|--------|-------|----------|-------|------------------|----------------------|------------|-------------------------|
| 6 | G1/4"-19-BSPP-A | M14X1.5-6H | 19.00 | 17.00 | 39.00 | 3.00 | 6.00 | XSP06SR | EVGE06SR | 14-16 | 630 |
| 8 | G1/4"-19-BSPP-A | M16X1.5-6H | 19.00 | 19.00 | 41.50 | 4.00 | 8.00 | XSP08SR | EVGE08SR | 25-28 | 630 |
| 10 | G3/8"-19-BSPP-A | M18X1.5-6H | 22.00 | 22.00 | 44.00 | 6.00 | 10.00 | XSP10SR | EVGE10SR | 27-30 | 630 |
| 12 | G3/8"-19-BSPP-A | M20X1.5-6H | 22.00 | 24.00 | 46.00 | 7.00 | 12.00 | XSP12SR | EVGE12SR | 43-54 | 630 |
| 14 | G1/2"-14-BSPP-A | M22X1.5-6H | 27.00 | 27.00 | 50.50 | 9.00 | 14.00 | XSP14SR | EVGE14SR | 50-62 | 630 |
| 16 | G1/2"-14-BSPP-A | M24X1.5-6H | 27.00 | 30.00 | 51.00 | 11.00 | 16.00 | XSP16SR | EVGE16SR | 60-75 | 400 |
| 20 | G3/4"-14-BSPP-A | M30X2.0-6H | 32.00 | 36.00 | 59.00 | 15.00 | 20.00 | XSP20SR | EVGE20SR | 90-110 | 400 |
| 25 | G1"-11-BSPP-A | M36X2.0-6H | 41.00 | 46.00 | 66.00 | 17.00 | 25.00 | XSP25SR | EVGE25SR | 125-145 | 400 |
| 30 | G1-1/4"-11-BSPP-A | M42X2.0-6H | 50.00 | 50.00 | 71.00 | 22.00 | 30.00 | XSP30SR | EVGE30SR | 170-190 | 250 |
| 38 | G1-1/2"-11-BSPP-A | M52X2.0-6H | 55.00 | 60.00 | 82.00 | 28.00 | 38.00 | XSP38SR | EVGE38SR | 200-245 | 250 |

| Material | Suffix surface and material | Example |
|-------------------------------------|-----------------------------|---------------|
| Steel ,Zinc plated chrome (VI)-free | | XSP06LR |
| Steel ,Zinc nickel plated | ZiNi | XSP06LR-ZINI |
| Stainless Steel-SS316 | SS316 | XSP06LR-SS316 |
| Stainless Steel-SS304 | SS304 | XSP06LR-SS304 |

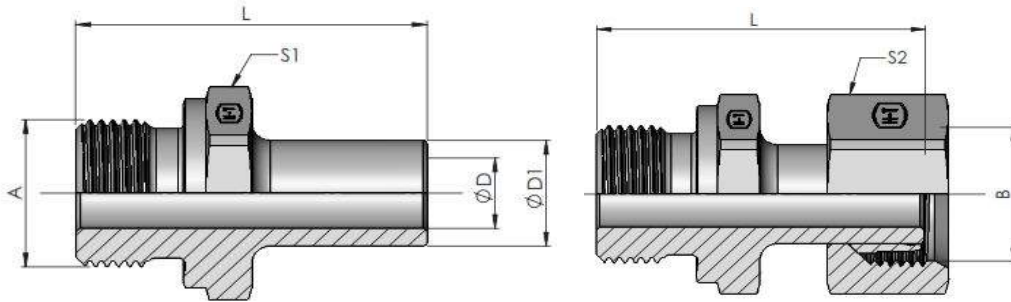

**EVGE-M-Stand Pipe Adaptor with nut and ferrule
L SERIES**

| Tube O.D. | A THREAD | B THREAD | S1 Hex | S2 Hex | L | ØD DRILL | ØD1 | Body Part Number | Assembly Part Number | Torque N-m | Working pressure in Bar |
|-----------|------------|------------|--------|--------|-------|----------|-------|------------------|----------------------|------------|-------------------------|
| 6 | M10X1.5-6g | M12X1.5-6H | 14.00 | 14.00 | 32.50 | 4.00 | 6.00 | XSP06LM | EVGE06LM | 13-15 | 250 |
| 8 | M12X1.5-6g | M14X1.5-6H | 17.00 | 17.00 | 38.50 | 6.00 | 8.00 | XSP08LM | EVGE08LM | 15-18 | 250 |
| 10 | M14X1.5-6g | M16X1.5-6H | 19.00 | 19.00 | 39.50 | 7.00 | 10.00 | XSP10LM | EVGE10LM | 25-28 | 250 |
| 12 | M16X1.5-6g | M18X1.5-6H | 22.00 | 22.00 | 41.50 | 9.00 | 12.00 | XSP12LM | EVGE12LM | 27-30 | 250 |
| 15 | M18X1.5-6g | M22X1.5-6H | 24.00 | 27.00 | 43.50 | 11.00 | 15.00 | XSP15LM | EVGE15LM | 50-60 | 250 |
| 18 | M22X1.5-6g | M26X1.5-6H | 27.00 | 32.00 | 45.50 | 18.00 | 18.00 | XSP18LM | EVGE18LM | 60-75 | 160 |
| 22 | M26X1.5-6g | M30X2.0-6H | 32.00 | 36.00 | 48.50 | 18.00 | 22.00 | XSP22LM | EVGE22LM | 85-105 | 160 |
| 28 | M33X2.0-6g | M36X2.0-6H | 41.00 | 41.00 | 53.00 | 23.00 | 28.00 | XSP28LM | EVGE28LM | 120-140 | 100 |
| 35 | M42X2.0-6g | M45X2.0-6H | 50.00 | 50.00 | 62.50 | 30.00 | 35.00 | XSP35LM | EVGE35LM | 170-190 | 100 |
| 42 | M48X2.0-6g | M52X2.0-6H | 55.00 | 60.00 | 68.20 | 36.00 | 42.00 | XSP42LM | EVGE42LM | 190-230 | 100 |

S SERIES

| Tube O.D. | A THREAD | B THREAD | S1 Hex | S2 Hex | L | ØD DRILL | ØD1 | Body Part Number | Assembly Part Number | Torque N-m | Working pressure in Bar |
|-----------|------------|------------|--------|--------|-------|----------|-------|------------------|----------------------|------------|-------------------------|
| 6 | M12X1.5-6g | M14X1.5-6H | 17.00 | 17.00 | 39.00 | 4.00 | 6.00 | XSP06SM | EVGE06SM | 14-16 | 630 |
| 8 | M14X1.5-6g | M16X1.5-6H | 19.00 | 19.00 | 41.50 | 5.00 | 8.00 | XSP08SM | EVGE08SM | 25-28 | 630 |
| 10 | M16X1.5-6g | M18X1.5-6H | 22.00 | 22.00 | 44.00 | 7.00 | 10.00 | XSP10SM | EVGE10SM | 27-30 | 630 |
| 12 | M18X1.5-6g | M20X1.5-6H | 24.00 | 24.00 | 46.00 | 8.00 | 12.00 | XSP12SM | EVGE12SM | 43-54 | 630 |
| 14 | M20X1.5-6g | M22X1.5-6H | 27.00 | 27.00 | 50.00 | 10.00 | 14.00 | XSP14SM | EVGE14SM | 50-62 | 630 |
| 16 | M22X1.5-6g | M24X1.5-6H | 27.00 | 30.00 | 51.00 | 12.00 | 16.00 | XSP16SM | EVGE16SM | 60-75 | 400 |
| 20 | M27X2.0-6g | M30X2.0-6H | 32.00 | 36.00 | 59.00 | 16.00 | 20.00 | XSP20SM | EVGE20SM | 90-110 | 400 |
| 25 | M33X2.0-6g | M36X2.0-6H | 41.00 | 46.00 | 66.00 | 20.00 | 25.00 | XSP25SM | EVGE25SM | 125-145 | 400 |
| 30 | M42X2.0-6g | M42X2.0-6H | 50.00 | 50.00 | 71.00 | 25.00 | 30.00 | XSP30SM | EVGE30SM | 170-190 | 250 |
| 38 | M48X2.0-6g | M52X2.0-6H | 55.00 | 60.00 | 82.00 | 32.00 | 38.00 | XSP38SM | EVGE38SM | 200-245 | 250 |

| Material | Suffix surface and material | Example |
|-------------------------------------|-----------------------------|---------------|
| Steel ,Zinc plated chrome (VI)-free | | XSP06LM |
| Steel ,Zinc nickel plated | ZiNi | XSP06LM-ZINI |
| Stainless Steel-SS316 | SS316 | XSP06LM-SS316 |
| Stainless Steel-SS304 | SS304 | XSP06LM-SS304 |

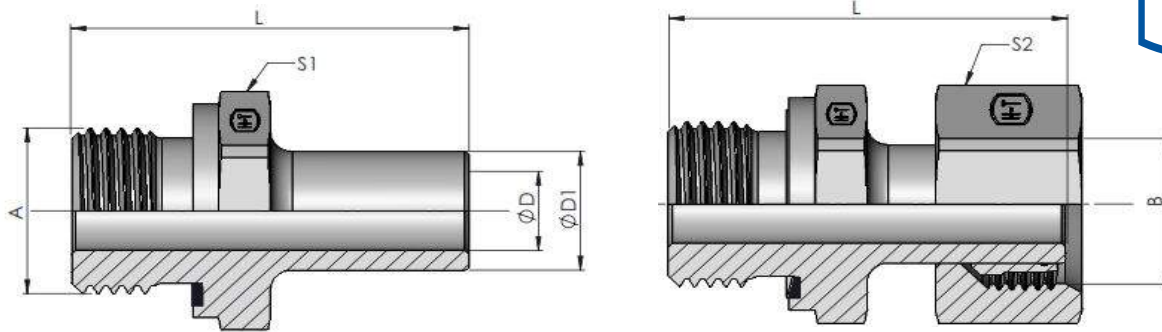

**EVGE-R-ED -Stand Pipe Adaptor with nut and ferrule
L SERIES**

| Tube O.D. | A THREAD | B THREAD | S1 Hex | S2 Hex | L | ØD DRILL | ØD1 | Body Part Number | Assembly Part Number | Torque N-m | Working pressure in Bar |
|-----------|-------------------|------------|--------|--------|-------|----------|-------|------------------|----------------------|------------|-------------------------|
| 6 | G1/8"-28-BSPP-A | M12X1.5-6H | 14.00 | 14.00 | 32.50 | 3.00 | 6.00 | XSP06LRED | EVGE06LRED | 13-15 | 250 |
| 8 | G1/4"-19-BSPP-A | M14X1.5-6H | 19.00 | 17.00 | 41.50 | 4.00 | 8.00 | XSP08LRED | EVGE08LRED | 15-18 | 250 |
| 10 | G1/4"-19-BSPP-A | M16X1.5-6H | 19.00 | 19.00 | 39.50 | 6.00 | 10.00 | XSP10LRED | EVGE10LRED | 25-28 | 250 |
| 12 | G3/8"-19-BSPP-A | M18X1.5-6H | 22.00 | 22.00 | 46.00 | 7.00 | 12.00 | XSP12LRED | EVGE12LRED | 27-30 | 250 |
| 15 | G1/2"-14-BSPP-A | M22X1.5-6H | 27.00 | 27.00 | 46.00 | 10.00 | 15.00 | XSP15LRED | EVGE15LRED | 50-60 | 250 |
| 18 | G1/2"-14-BSPP-A | M26X1.5-6H | 27.00 | 32.00 | 45.50 | 13.00 | 18.00 | XSP18LRED | EVGE18LRED | 60-75 | 160 |
| 22 | G3/4"-14-BSPP-A | M30X2.0-6H | 32.00 | 36.00 | 48.50 | 16.00 | 22.00 | XSP22LRED | EVGE22LRED | 85-105 | 160 |
| 28 | G1"-11-BSPP-A | M36X2.0-6H | 41.00 | 41.00 | 53.00 | 22.00 | 28.00 | XSP28LRED | EVGE28LRED | 120-140 | 100 |
| 35 | G1-1/4"-11-BSPP-A | M45X2.0-6H | 50.00 | 50.00 | 62.50 | 28.00 | 35.00 | XSP35LRED | EVGE35LRED | 170-190 | 100 |
| 42 | G1-1/2"-11-BSPP-A | M52X2.0-6H | 55.00 | 60.00 | 68.50 | 34.00 | 42.00 | XSP42LRED | EVGE42LRED | 190-230 | 100 |

S SERIES

| Tube O.D. | A THREAD | B THREAD | S1 Hex | S2 Hex | L | ØD DRILL | ØD1 | Body Part Number | Assembly Part Number | Torque N-m | Working pressure in Bar |
|-----------|-------------------|------------|--------|--------|-------|----------|-------|------------------|----------------------|------------|-------------------------|
| 6 | G1/4"-19-BSPP-A | M14X1.5-6H | 19.00 | 17.00 | 39.00 | 3.00 | 6.00 | XSP06SRED | EVGE06SRED | 14-16 | 630 |
| 8 | G1/4"-19-BSPP-A | M16X1.5-6H | 19.00 | 19.00 | 41.50 | 4.00 | 8.00 | XSP08SRED | EVGE08SRED | 25-28 | 630 |
| 10 | G3/8"-19-BSPP-A | M18X1.5-6H | 22.00 | 22.00 | 44.00 | 6.00 | 10.00 | XSP10SRED | EVGE10SRED | 27-30 | 630 |
| 12 | G3/8"-19-BSPP-A | M20X1.5-6H | 22.00 | 24.00 | 46.00 | 7.00 | 12.00 | XSP12SRED | EVGE12SRED | 43-54 | 630 |
| 14 | G1/2"-14-BSPP-A | M22X1.5-6H | 27.00 | 27.00 | 50.50 | 9.00 | 14.00 | XSP14SRED | EVGE14SRED | 50-62 | 630 |
| 16 | G1/2"-14-BSPP-A | M24X1.5-6H | 27.00 | 30.00 | 51.00 | 11.00 | 16.00 | XSP16SRED | EVGE16SRED | 60-75 | 400 |
| 20 | G3/4"-14-BSPP-A | M30X2.0-6H | 32.00 | 36.00 | 59.00 | 15.00 | 20.00 | XSP20SRED | EVGE20SRED | 90-110 | 400 |
| 25 | G1"-11-BSPP-A | M36X2.0-6H | 41.00 | 46.00 | 66.00 | 17.00 | 25.00 | XSP25SRED | EVGE25SRED | 125-145 | 400 |
| 30 | G1-1/4"-11-BSPP-A | M42X2.0-6H | 50.00 | 50.00 | 71.00 | 22.00 | 30.00 | XSP30SRED | EVGE30SRED | 170-190 | 250 |
| 38 | G1-1/2"-11-BSPP-A | M52X2.0-6H | 55.00 | 60.00 | 82.00 | 28.00 | 38.00 | XSP38SRED | EVGE38SRED | 200-245 | 250 |

| Material | Suffix surface and material | Example |
|-------------------------------------|-----------------------------|-----------------|
| Steel ,Zinc plated chrome (VI)-free | | XSP06LRED |
| Steel ,Zinc nickel plated | ZiNi | XSP06LRED-ZINI |
| Stainless Steel-SS316 | SS316 | XSP06LRED-SS316 |
| Stainless Steel-SS304 | SS304 | XSP06LRED-SS304 |

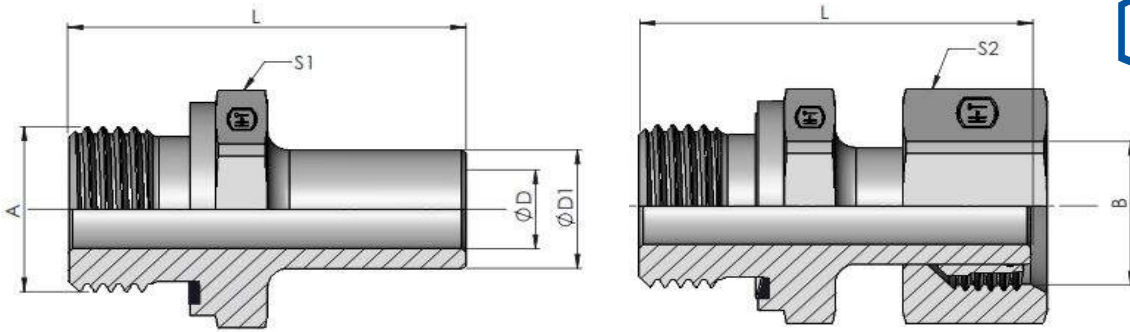

**EVGE-M-ED -Stand Pipe Adaptor with nut and ferrule
L SERIES**

| Tube O.D. | A THREAD | B THREAD | S1 Hex | S2 Hex | L | ØD DRILL | ØD1 | Body Part Number | Assembly Part Number | Torque N-m | Working pressure in Bar |
|-----------|------------|------------|--------|--------|-------|----------|-------|------------------|----------------------|------------|-------------------------|
| 6 | M10X1.5-6g | M12X1.5-6H | 14.00 | 14.00 | 32.50 | 4.00 | 6.00 | XSP06LMED | SP 6-LMED | 13-15 | 250 |
| 8 | M12X1.5-6g | M14X1.5-6H | 17.00 | 17.00 | 38.50 | 6.00 | 8.00 | XSP08LMED | SP 8-LMED | 15-18 | 250 |
| 10 | M14X1.5-6g | M16X1.5-6H | 19.00 | 19.00 | 39.50 | 7.00 | 10.00 | XSP10LMED | SP 10-LMED | 25-28 | 250 |
| 12 | M16X1.5-6g | M18X1.5-6H | 22.00 | 22.00 | 41.50 | 9.00 | 12.00 | XSP12LMED | SP 12-LMED | 27-30 | 250 |
| 15 | M18X1.5-6g | M22X1.5-6H | 24.00 | 27.00 | 43.50 | 11.00 | 15.00 | XSP15LMED | SP 15-LMED | 50-60 | 250 |
| 18 | M22X1.5-6g | M26X1.5-6H | 27.00 | 32.00 | 45.50 | 18.00 | 18.00 | XSP18LMED | SP 18-LMED | 60-75 | 160 |
| 22 | M26X1.5-6g | M30X2.0-6H | 32.00 | 36.00 | 48.50 | 18.00 | 22.00 | XSP22LMED | SP 22-LMED | 85-105 | 160 |
| 28 | M33X2.0-6g | M36X2.0-6H | 41.00 | 41.00 | 53.00 | 23.00 | 28.00 | XSP28LMED | SP 28-LMED | 120-140 | 100 |
| 35 | M42X2.0-6g | M45X2.0-6H | 50.00 | 50.00 | 62.50 | 30.00 | 35.00 | XSP35LMED | SP 35-LMED | 170-190 | 100 |
| 42 | M48X2.0-6g | M52X2.0-6H | 55.00 | 60.00 | 68.50 | 36.00 | 42.00 | XSP42LMED | SP 42-LMED | 190-230 | 100 |

S SERIES

| Tube O.D. | A THREAD | B THREAD | S1 Hex | S2 Hex | L | ØD DRILL | ØD1 | Body Part Number | Assembly Part Number | Torque N-m | Working pressure in Bar |
|-----------|------------|------------|--------|--------|-------|----------|-------|------------------|----------------------|------------|-------------------------|
| 6 | M12X1.5-6g | M14X1.5-6H | 17.00 | 17.00 | 39.00 | 4.00 | 6.00 | XSP06SMED | SP 6-SMED | 14-16 | 630 |
| 8 | M14X1.5-6g | M16X1.5-6H | 19.00 | 19.00 | 41.50 | 5.00 | 8.00 | XSP08SMED | SP 8-SMED | 25-28 | 630 |
| 10 | M16X1.5-6g | M18X1.5-6H | 22.00 | 22.00 | 44.00 | 7.00 | 10.00 | XSP10SMED | SP 10-SMED | 27-30 | 630 |
| 12 | M18X1.5-6g | M20X1.5-6H | 24.00 | 24.00 | 46.00 | 8.00 | 12.00 | XSP12SMED | SP 12-SMED | 43-54 | 630 |
| 14 | M20X1.5-6g | M22X1.5-6H | 27.00 | 27.00 | 50.00 | 10.00 | 14.00 | XSP14SMED | SP 14-SMED | 50-62 | 630 |
| 16 | M22X1.5-6g | M24X1.5-6H | 27.00 | 30.00 | 51.00 | 12.00 | 16.00 | XSP16SMED | SP 16-SMED | 60-75 | 400 |
| 20 | M27X2.0-6g | M30X2.0-6H | 32.00 | 36.00 | 59.00 | 16.00 | 20.00 | XSP20SMED | SP 20-SMED | 90-110 | 400 |
| 25 | M33X2.0-6g | M36X2.0-6H | 41.00 | 46.00 | 66.00 | 20.00 | 25.00 | XSP25SMED | SP 25-SMED | 125-145 | 400 |
| 30 | M42X2.0-6g | M42X2.0-6H | 50.00 | 50.00 | 71.00 | 25.00 | 30.00 | XSP30SMED | SP 30-SMED | 170-190 | 250 |
| 38 | M48X2.0-6g | M52X2.0-6H | 55.00 | 60.00 | 82.00 | 32.00 | 38.00 | XSP38SMED | SP 38-SMED | 200-245 | 250 |

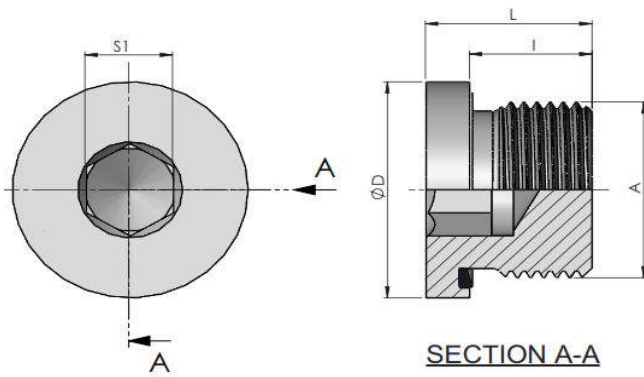
| Material | Suffix surface and material | Example |
|-------------------------------------|-----------------------------|-----------------|
| Steel ,Zinc plated chrome (VI)-free | | XSP06LMED |
| Steel ,Zinc nickel plated | ZiNi | XSP06LMED-ZINI |
| Stainless Steel-SS316 | SS316 | XSP06LMED-SS316 |
| Stainless Steel-SS304 | SS304 | XSP06LMED-SS304 |



C-29

VSTI-R-Hollow Hex Plug

| A THREAD | L LENGTH | I | ØD | S1 A/F Hex | Part Number | Torque N-m | Working pressure in Bar |
|-------------------|-------------|-------|-------|------------------|------------------|---------------|-------------------------|
| G1/8"-28-BSPP-A | 12.00 | 8.00 | 14.00 | 5.00 | VSTIR1-8"BSPED | 20-22 | 400 |
| G1/4"-19-BSPP-A | 17.00 | 12.00 | 19.00 | 6.00 | VSTIR1-4"BSPED | 60-66 | 400 |
| G3/8"-19-BSPP-A | 17.00 | 12.00 | 22.00 | 8.00 | VSTIR3-8"BSPED | 90-99 | 400 |
| G1/2"-14-BSPP-A | 19.00 | 14.00 | 27.00 | 10.00 | VSTIR1-2"BSPED | 130-143 | 400 |
| G3/4"-14-BSPP-A | 21.00 | 16.00 | 32.00 | 12.00 | VSTIR3-4"BSPED | 200-220 | 400 |
| G1"-11-BSPP-A | 22.50 | 16.00 | 40.00 | 17.00 | VSTIR1"BSPED | 380-418 | 400 |
| G1-1/4"-11-BSPP-A | 22.50 | 16.00 | 50.00 | 22.00 | VSTIR1-1-4"BSPED | 500-550 | 250 |
| G1-1/2"-11-BSPP-A | 22.50 | 16.00 | 55.00 | 24.00 | VSTIR1-1-2"BSPED | 600-660 | 250 |

| Material | Suffix surface and material | Example |
|-------------------------------------|-----------------------------|----------------------|
| Steel ,Zinc plated chrome (VI)-free | | VSTIR1-8"BSPED |
| Steel ,Zinc nickel plated | ZiNi | VSTIR1-8"BSPED-ZINI |
| Stainless Steel-SS316 | SS316 | VSTIR1-8"BSPED-SS316 |
| Stainless Steel-SS304 | SS304 | VSTIR1-8"BSPED-SS304 |

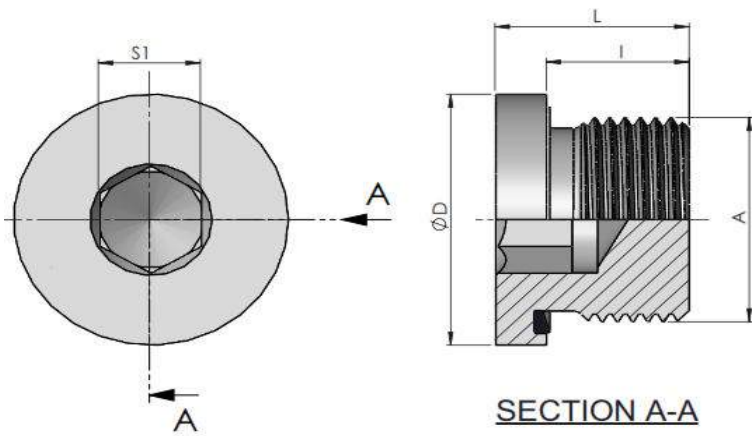

C-30

VSTI-M-Hollow Hex Plug

| A THREAD | L LENGTH | I | ØD | S1 A/F Hex | Part Number | Torque N-m | Working pressure in Bar |
|-------------|-------------|-------|-------|------------------|-----------------------|---------------|-------------------------|
| M10X1.0-6g | 12.00 | 8.00 | 14.00 | 5.00 | VSTI-M10X1.0ED | 20-22 | 400 |
| M12X1.5-6g | 17.00 | 12.00 | 17.00 | 6.00 | VSTI-M12X1.5ED | 45-49.5 | 400 |
| M14X1.5-6g | 17.00 | 12.00 | 19.00 | 6.00 | VSTI-M14X1.5ED | 60-66 | 400 |
| M16X1.5-6g | 17.00 | 12.00 | 22.00 | 8.00 | VSTI-M16X1.5ED | 80-88 | 400 |
| M18X1.5-6g | 17.00 | 12.00 | 24.00 | 8.00 | VSTI-M18X1.5ED | 100-110 | 400 |
| M20X1.5-6g | 19.00 | 14.00 | 26.00 | 10.00 | VSTI-M20X1.5ED | 140-154 | 400 |
| M22X1.5-6g | 19.00 | 14.00 | 27.00 | 10.00 | VSTI-M22X1.5ED | 150-165 | 400 |
| M26X1.5-6g | 21.00 | 16.00 | 32.00 | 12.00 | VSTI-M26X1.5ED | 200-220 | 400 |
| M27X2.0-6g | 21.00 | 16.00 | 32.00 | 12.00 | VSTI-M27X2.0ED | 200-220 | 400 |
| M33X2.0-6g | 22.50 | 16.00 | 40.00 | 17.00 | VSTI-M33X2.0ED | 380-418 | 400 |
| M42X2.0-6g | 22.50 | 16.00 | 50.00 | 22.00 | VSTI-M42X2.0ED | 500-550 | 250 |
| M48X2.0-6g | 22.50 | 16.00 | 55.00 | 24.00 | VSTI-M48X2.0ED | 600-660 | 250 |

| Material | Suffix surface and material | Example |
|-------------------------------------|-----------------------------|----------------------|
| Steel ,Zinc plated chrome (VI)-free | | VSTI-M10X1.0ED |
| Steel ,Zinc nickel plated | ZiNi | VSTI-M10X1.0ED-ZINI |
| Stainless Steel-SS316 | SS316 | VSTI-M10X1.0ED-SS316 |
| Stainless Steel-SS304 | SS304 | VSTI-M10X1.0ED-SS304 |

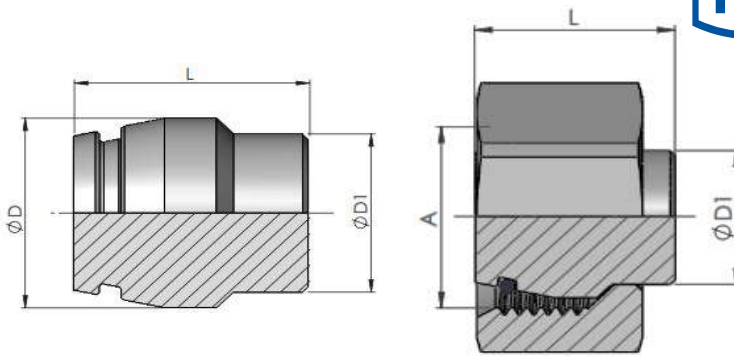

**VKA-Cap
L SERIES**

| Tube O.D. | L LENGTH | ØD1 | ØD | Body Part Number | Assembly Part Number | Torque N-m | Working pressure in Bar |
|-----------|----------|-------|-------|------------------|----------------------|------------|-------------------------|
| 6 | 18.50 | 6.00 | 9.90 | XVKA06L | VKA06L | 13-15 | 250 |
| 8 | 18.50 | 8.00 | 11.90 | XVKA08L | VKA08L | 15-18 | 250 |
| 10 | 20.00 | 10.00 | 13.00 | XVKA10L | VKA10L | 25-28 | 250 |
| 12 | 20.50 | 12.00 | 15.00 | XVKA12L | VKA12L | 27-30 | 250 |
| 15 | 20.50 | 15.00 | 18.00 | XVKA15L | VKA15L | 50-60 | 250 |
| 18 | 22.50 | 18.00 | 21.70 | XVKA18L | VKA18L | 60-75 | 160 |
| 22 | 25.00 | 22.00 | 25.70 | XVKA22L | VKA22L | 85-105 | 160 |
| 28 | 25.50 | 28.00 | 31.50 | XVKA28L | VKA28L | 120-140 | 100 |
| 35 | 30.00 | 35.00 | 39.50 | XVKA35L | VKA35L | 170-190 | 100 |
| 42 | 30.00 | 42.00 | 47.00 | XVKA42L | VKA42L | 190-230 | 100 |

S SERIES

| Tube O.D. | L LENGTH | ØD1 | ØD2 | Body Part Number | Assembly Part Number | Torque N-m | Working pressure in Bar |
|-----------|----------|-------|-------|------------------|----------------------|------------|-------------------------|
| 6 | 18.50 | 6.00 | 9.90 | XVKA06S | VKA06S | 14-16 | 630 |
| 8 | 18.50 | 8.00 | 11.90 | XVKA08S | VKA08S | 25-28 | 630 |
| 10 | 20.00 | 10.00 | 13.00 | XVKA10S | VKA10S | 27-30 | 630 |
| 12 | 20.50 | 12.00 | 15.00 | XVKA12S | VKA12S | 43-54 | 630 |
| 14 | 22.50 | 14.00 | 17.00 | XVKA14S | VKA14S | 50-62 | 630 |
| 16 | 23.50 | 16.00 | 19.00 | XVKA16S | VKA16S | 60-75 | 400 |
| 20 | 28.50 | 20.00 | 24.00 | XVKA20S | VKA20S | 90-110 | 400 |
| 25 | 29.00 | 25.00 | 29.50 | XVKA25S | VKA25S | 125-145 | 400 |
| 30 | 30.50 | 30.00 | 34.50 | XVKA30S | VKA30S | 170-190 | 250 |
| 38 | 33.00 | 38.00 | 43.00 | XVKA38S | VKA38S | 200-245 | 250 |

| Material | Suffix surface and material | Example |
|-------------------------------------|-----------------------------|---------------|
| Steel ,Zinc plated chrome (VI)-free | | XVKA06L |
| Steel ,Zinc nickel plated | ZiNi | XVKA06L-ZINI |
| Stainless Steel-SS316 | SS316 | XVKA06L-SS316 |
| Stainless Steel-SS304 | SS304 | XVKA06L-SS304 |

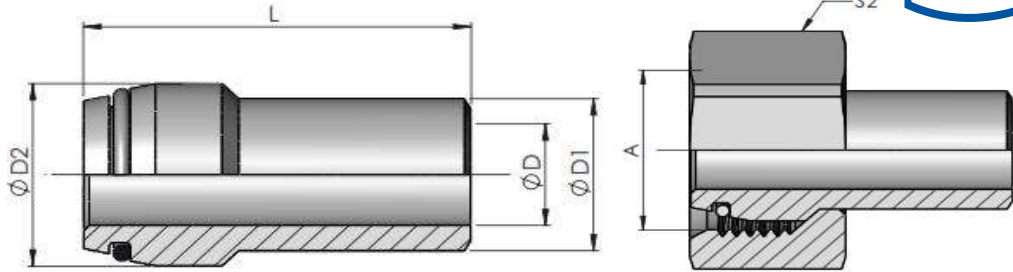

**VKA-Cap
L SERIES**

| Tube O.D. | ØD2 | L LENGTH | ØD1 | ØD | A THREAD | S2 Hex | Body Part Number | Assembly Part Number | Torque N-m | Working pressure in Bar |
|-----------|-------|----------|-------|-------|------------|--------|------------------|----------------------|------------|-------------------------|
| 6 | 9.20 | 31.50 | 6.00 | 3.00 | M12X1.5-6H | 14.00 | XWN06L | WN06L | 13-15 | 250 |
| 8 | 11.20 | 31.50 | 8.00 | 5.00 | M14X1.5-6H | 17.00 | XWN08L | WN08L | 15-18 | 250 |
| 10 | 14.00 | 32.50 | 10.00 | 7.00 | M16X1.5-6H | 19.00 | XWN10L | WN10L | 25-28 | 250 |
| 12 | 16.00 | 32.50 | 12.00 | 8.00 | M18X1.5-6H | 22.00 | XWN12L | WN12L | 27-30 | 250 |
| 15 | 18.20 | 34.50 | 15.00 | 10.00 | M22X1.5-6H | 27.00 | XWN15L | WN15L | 50-60 | 250 |
| 18 | 21.50 | 36.50 | 18.00 | 13.00 | M26X1.5-6H | 32.00 | XWN18L | WN18L | 60-75 | 160 |
| 22 | 25.70 | 38.00 | 22.00 | 17.00 | M30X2.0-6H | 36.00 | XWN22L | WN22L | 85-105 | 160 |
| 28 | 31.50 | 42.50 | 28.00 | 23.00 | M36X2.0-6H | 41.00 | XWN28L | WN28L | 120-140 | 100 |
| 35 | 40.00 | 49.50 | 35.00 | 29.00 | M45X2.0-6H | 50.00 | XWN35L | WN35L | 170-190 | 100 |
| 42 | 47.50 | 49.00 | 42.00 | 36.00 | M52X2.0-6H | 60.00 | XWN42L | WN42L | 190-230 | 100 |

S SERIES

| Tube O.D. | ØD2 | L LENGTH | ØD1 | ØD | A THREAD | S2 Hex | Body Part Number | Assembly Part Number | Torque N-m | Working pressure in Bar |
|-----------|-------|----------|-------|-------|------------|--------|------------------|----------------------|------------|-------------------------|
| 6 | 9.90 | 31.50 | 6.00 | 3.00 | M14X1.5-6H | 17.00 | XWN06S | WN06S | 14-16 | 630 |
| 8 | 11.90 | 31.50 | 8.00 | 5.00 | M16X1.5-6H | 19.00 | XWN08S | WN08S | 25-28 | 630 |
| 10 | 14.00 | 32.50 | 10.00 | 7.00 | M18X1.5-6H | 22.00 | XWN10S | WN10S | 27-30 | 630 |
| 12 | 16.30 | 33.50 | 12.00 | 8.00 | M20X1.5-6H | 24.00 | XWN12S | WN12S | 43-54 | 630 |
| 14 | 17.00 | 39.50 | 14.00 | 10.00 | M22X1.5-6H | 27.00 | XWN14S | WN14S | 50-62 | 630 |
| 16 | 19.50 | 38.00 | 16.00 | 11.00 | M24X1.5-6H | 30.00 | XWN16S | WN16S | 60-75 | 400 |
| 20 | 24.00 | 44.00 | 20.00 | 14.00 | M30X2.0-6H | 36.00 | XWN20S | WN20S | 90-110 | 400 |
| 25 | 29.00 | 49.00 | 25.00 | 17.00 | M36X2.0-6H | 46.00 | XWN25S | WN25S | 125-145 | 400 |
| 30 | 35.00 | 52.00 | 30.00 | 22.00 | M42X2.0-6H | 50.00 | XWN30S | WN30S | 170-190 | 250 |
| 38 | 43.00 | 56.50 | 38.00 | 28.00 | M52X2.0-6H | 60.00 | XWN38S | WN38S | 200-245 | 250 |

| Material | Suffix surface and material | Example |
|-------------------------------------|-----------------------------|--------------|
| Steel ,Zinc plated chrome (VI)-free | | XWN06L |
| Steel ,Zinc nickel plated | ZiNi | XWN06L-ZINI |
| Stainless Steel-SS316 | SS316 | XWN06L-SS316 |
| Stainless Steel-SS304 | SS304 | XWN06L-SS304 |